

eduard

LIMITED



Tornado IDS

STAVEBNÍ NÁVOD

1/48

11165-NAV1

ATTENTION



UPOZORNĚNÍ



ACHTUNG



ATTENTION



注意



Carefully read instruction sheet before assembling. When you use glue or paint, do not use near open flame and use in well ventilated room. Keep out of reach of small children. Children must not be allowed to suck any part, or pull vinyl bag over the head.



Před započatím stavby si pečlivě prostudujte stavební návod. Při používání barev a lepidel pracujte v dobře větrané místnosti. Lepidla ani barvy nepoužívejte v blízkosti otevřeného ohně. Model není určen malým dětem, mohlo by dojít k požití drobných dílů.

INSTRUCTION SIGNS * INSTR. SYMBOLS * INSTRUKTION SINNBILDEN * SYMBOLES * 記号の説明

OPTIONAL
VOLBABEND
OHNOUTSAND
BROUSITOPEN HOLE
VYVRTAT OTVORSYMETRICAL ASSEMBLY
SYMETRICKÁ MONTÁŽREMOVE
ODRÍZNOUTREVERSE SIDE
OTOČITAPPLY EDUARD MASK
AND PAINT
POUŽIT EDUARD MASK
NABARVIT

PARTS



DÍLY



TEILE



PIÈCES



部品

PLASTIC PARTS

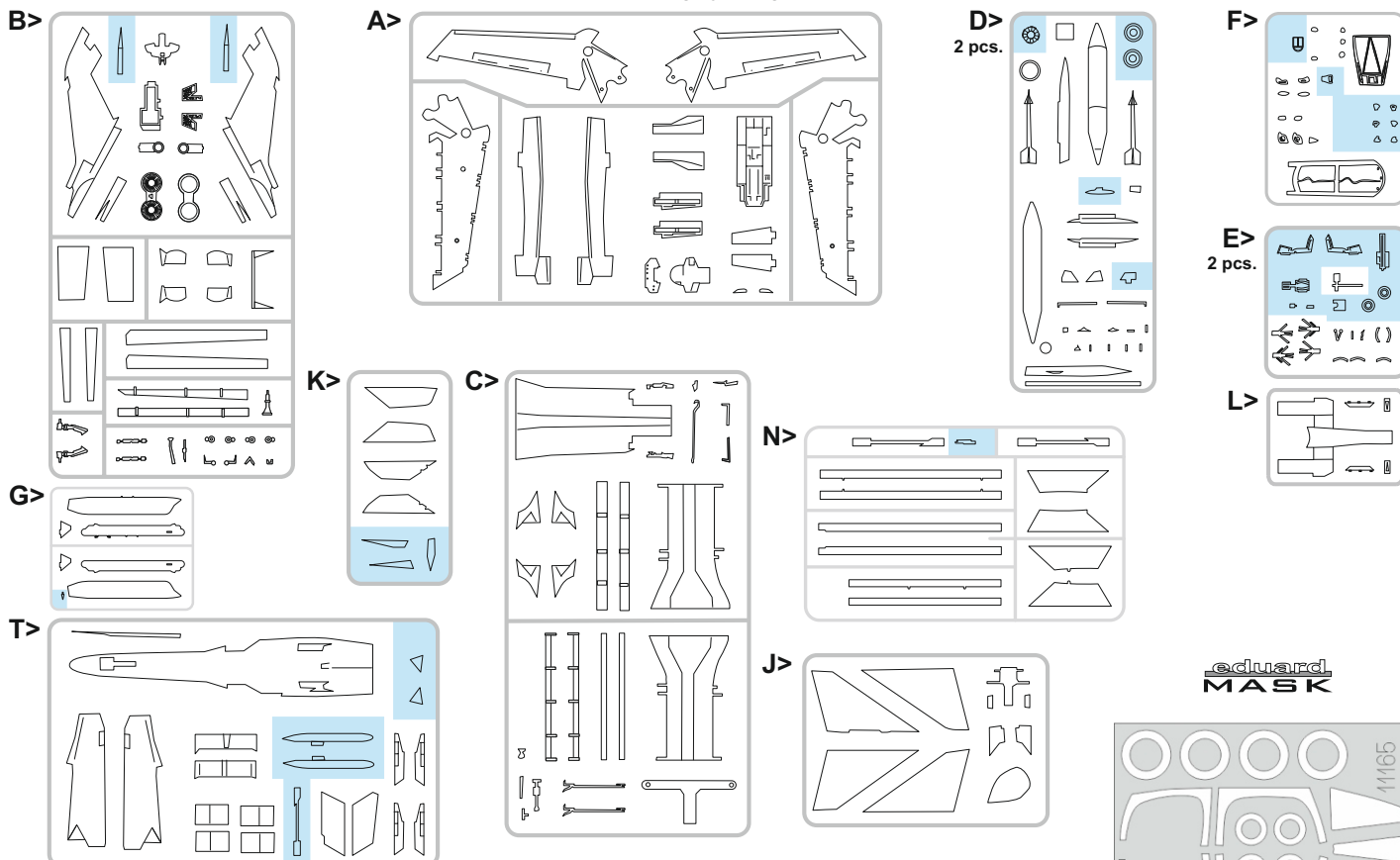

PE - PHOTO ETCHED DETAIL PARTS

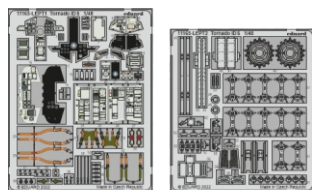

FILM

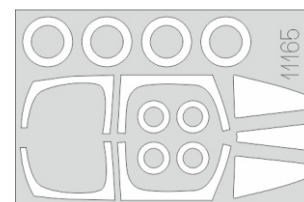

RP - RESIN PARTS

R6
2pcs.R7
2pcs.R8
2pcs.R9
2pcs.R10
2pcs.R11
2pcs.eduard
MASK

-Parts not for use. -Teile werden nicht verwendet. -Pièces à ne pas utiliser. -Tyto díly nepoužívejte při stavbě. - 使用しない部品

COLOURS



BARVY



FARBEN



PEINTURE



色

GSI Creos (GUNZE)		MISSION MODELS	
AQUEOUS	Mr.COLOR	PAINTS	
H2	C2	MMP-047	BLACK
H3	C3	MMP-003	RED
H11	C62	MMP-001	FLAT WHITE
H12	C33	MMP-047	FLAT BLACK
H44	C51		FLESH
H52	C12	MMP-091	OLIVE DRAB
H53	C13		NEUTRAL GRAY
H54	C365		NAVY BLUE
H68	C36	MMP-049	RLM74 DARK GRAY
H69	C37	MMP-066	RLM75 GRAY
H77	C137	MMP-040	TIRE BLACK
H82	C31		DARK GRAY
H90	C47		CLEAR RED
H94	C138		CLEAR GREEN
H301	C301	MMP-099	GRAY
H303	C303	MMP-066	GREEN
H305	C305	MMP-084	GRAY

GSI Creos (GUNZE)			MISSION MODELS
AQUEOUS	Mr.COLOR	PAINTS	
H306	C306	MMP-118	MEDIUM GRAY
H307	C307	MMP-074	GRAY
H308	C308	MMP-073	GRAY
H309	C309	MMP-031	GREEN
H317	C317	MMP-064	GRAY
H331	C331		DARK SEAGRAY
H334	C334	MMP-102	BARLEY GRAY
H338	C338	MMP-116	LIGHT GRAY
H421	C121	MMP-052	BROWN VIOLET
Mr.METAL COLOR		METALLICS	
MC211			CHROME SILVER
MC213		MMM-006	STAINLESS
MC214		MMM-001	DARK IRON
MC218		MMM-001	ALUMINIUM
Mr.COLOR SUPER METALLIC		METALLICS	
SM201		MMC-001	SUPER FINE SILVER

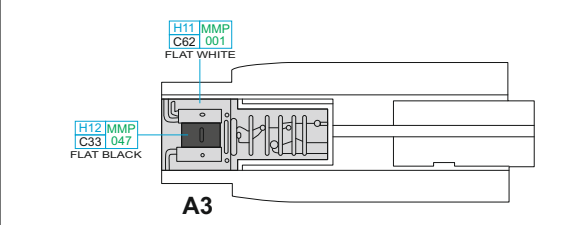
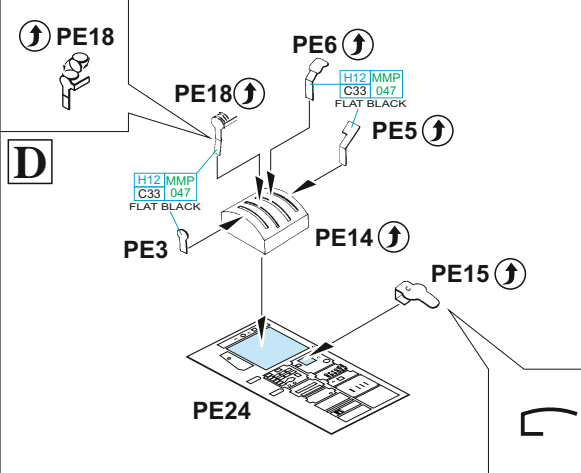
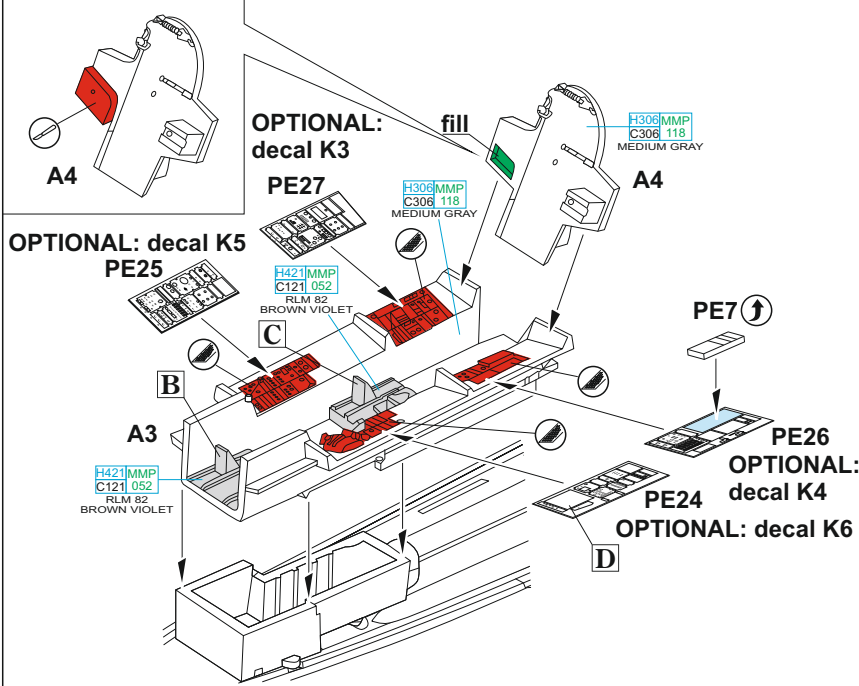
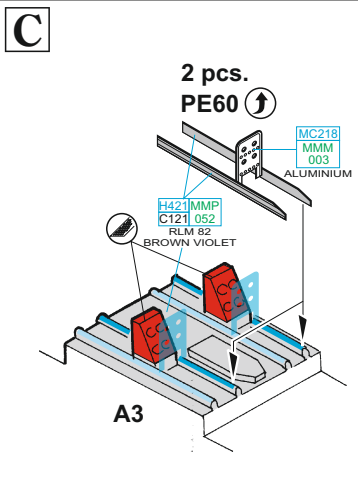
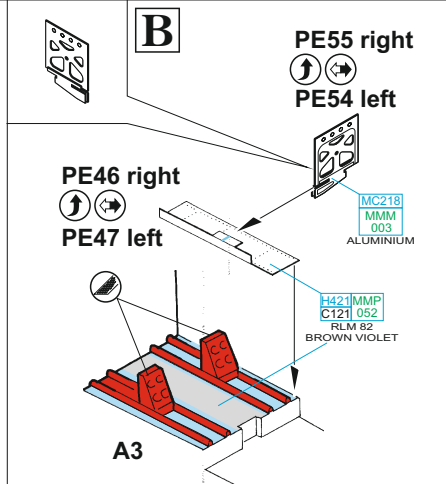
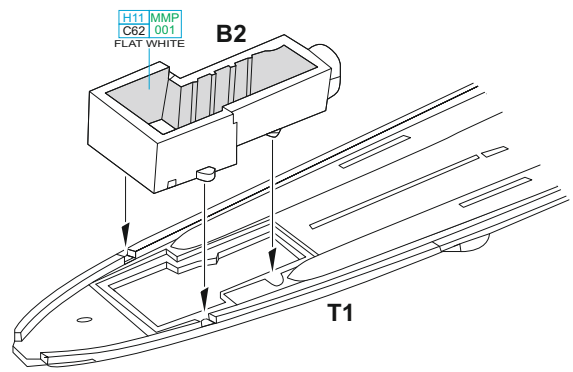
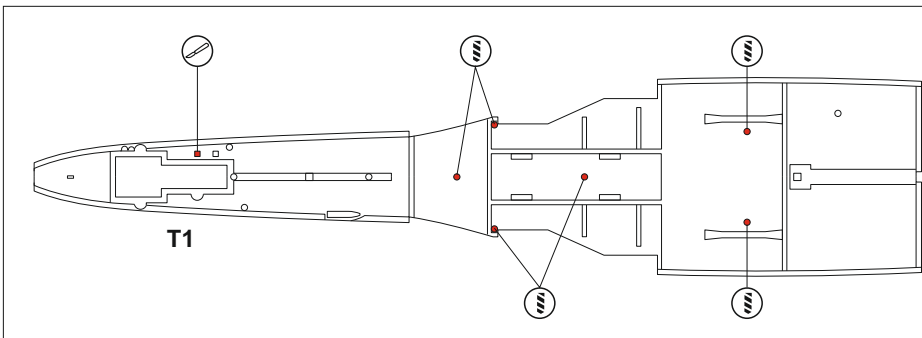
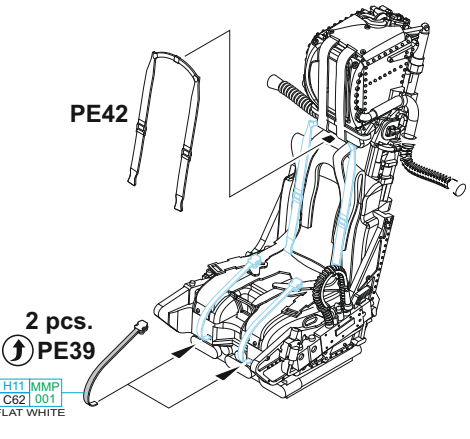
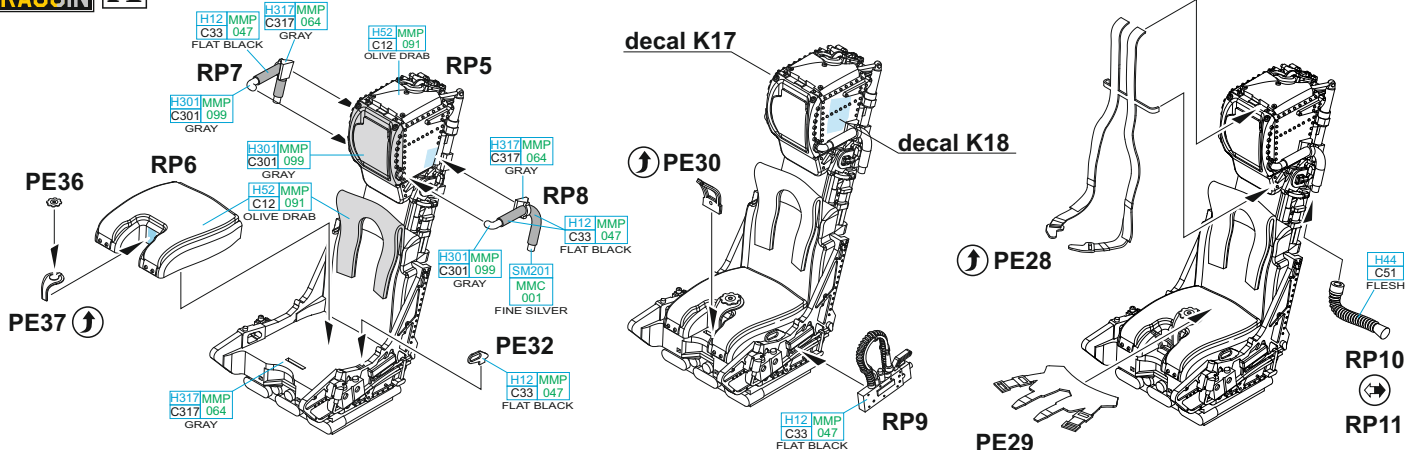

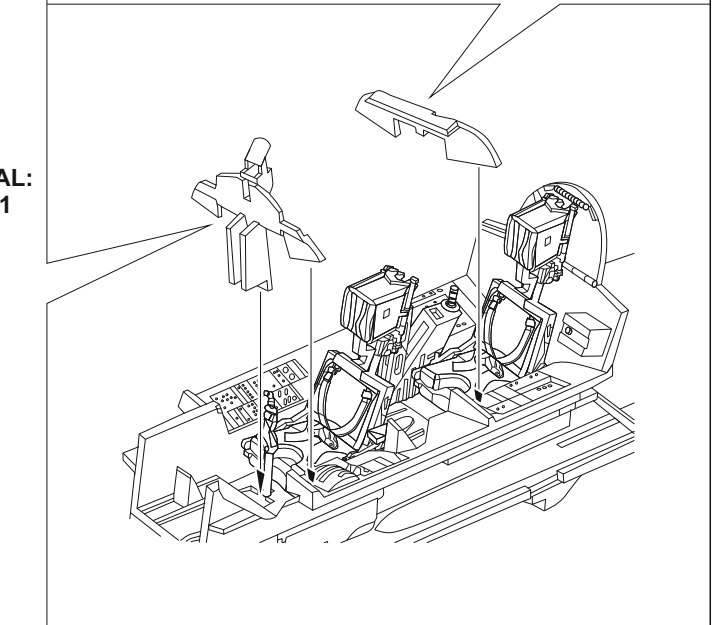
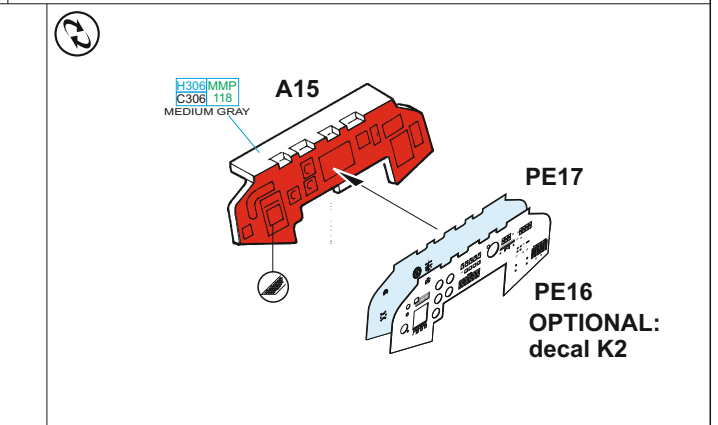
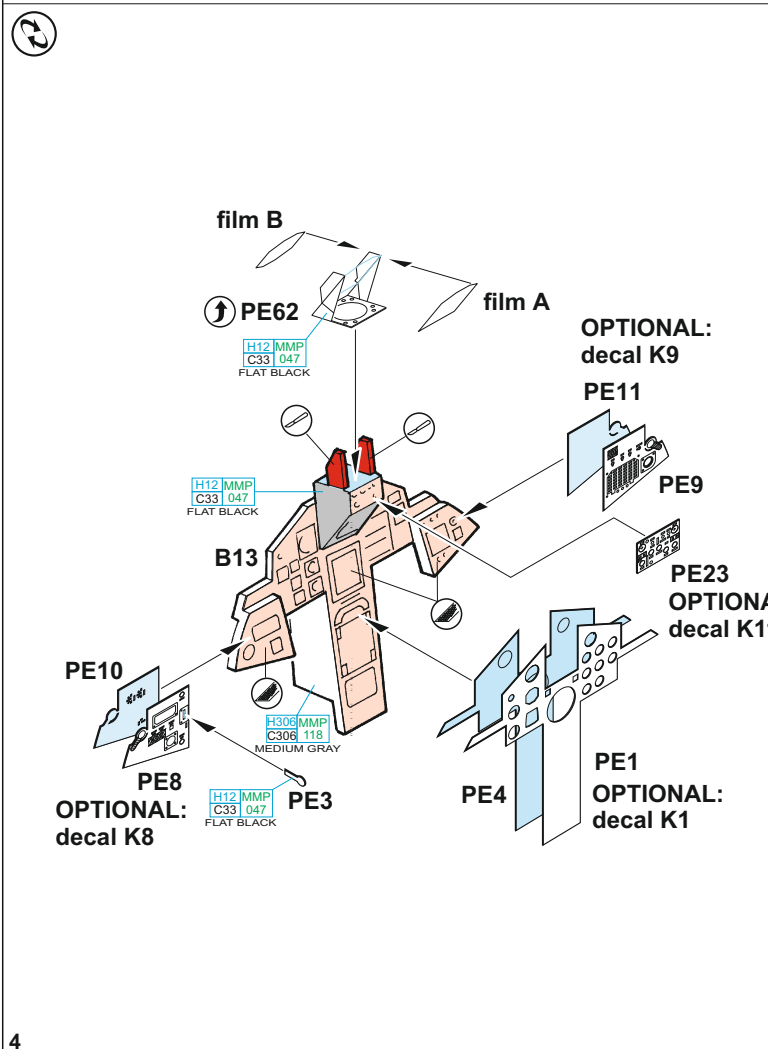
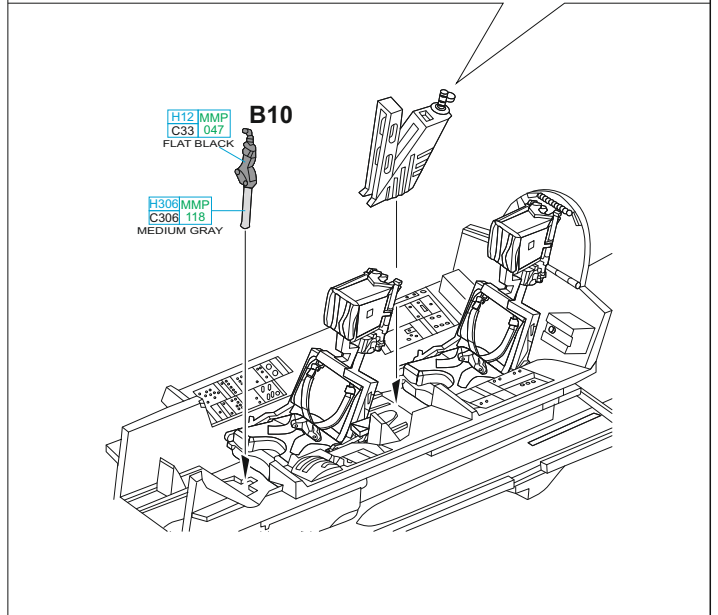
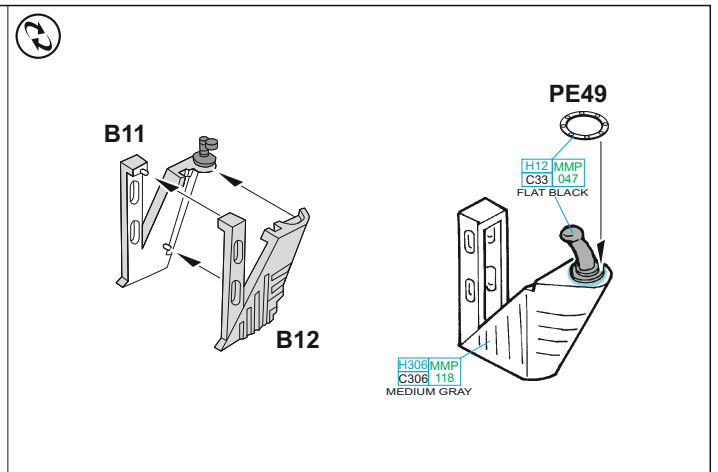
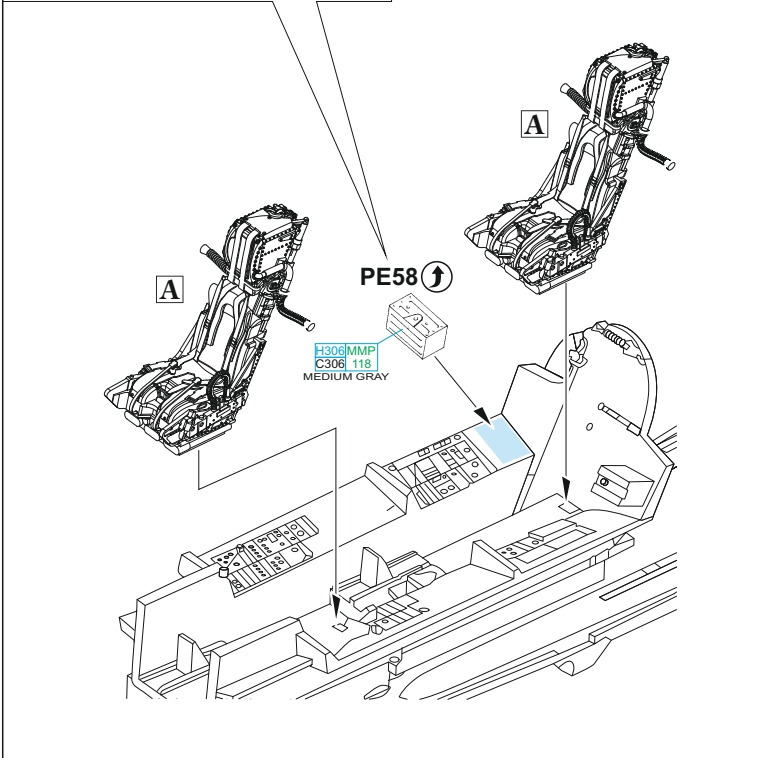
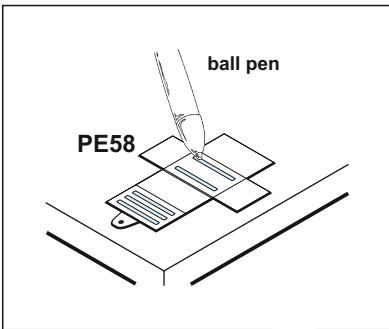

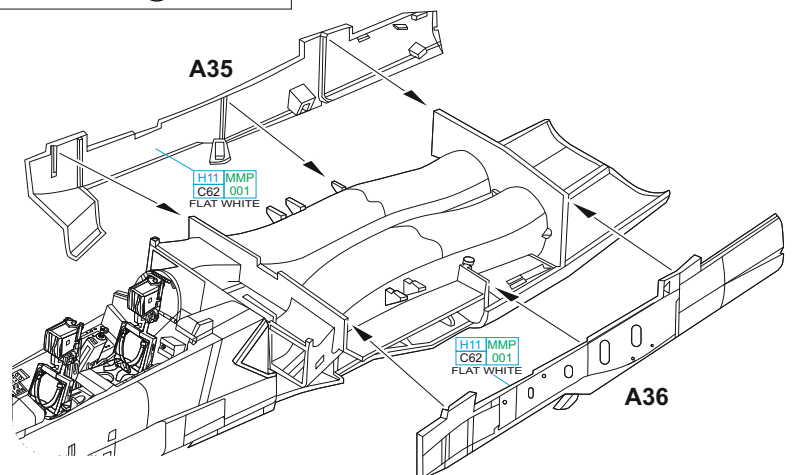
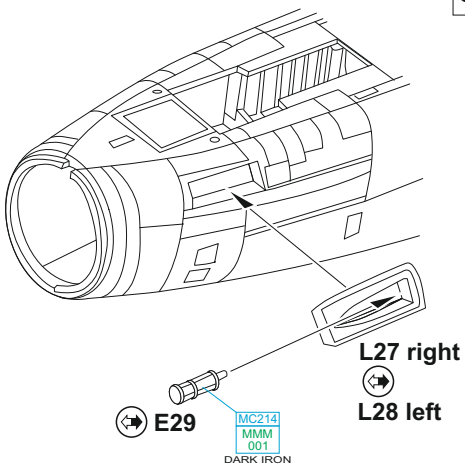
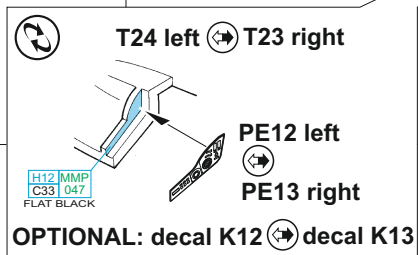
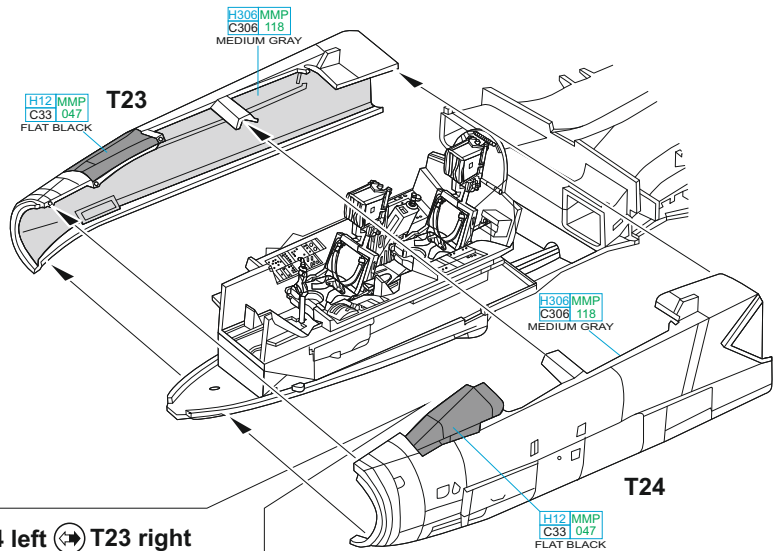
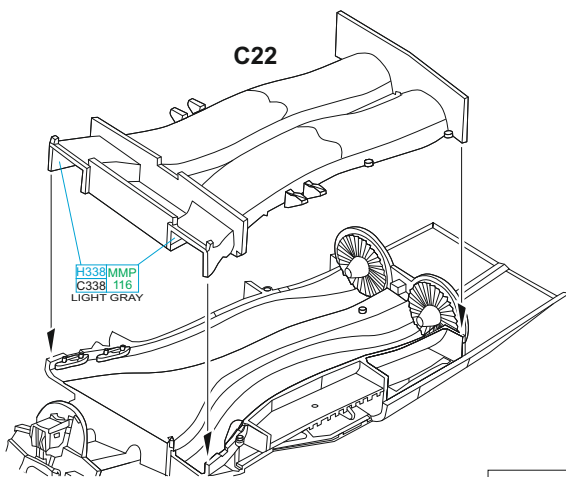
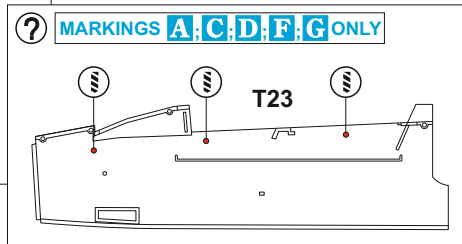
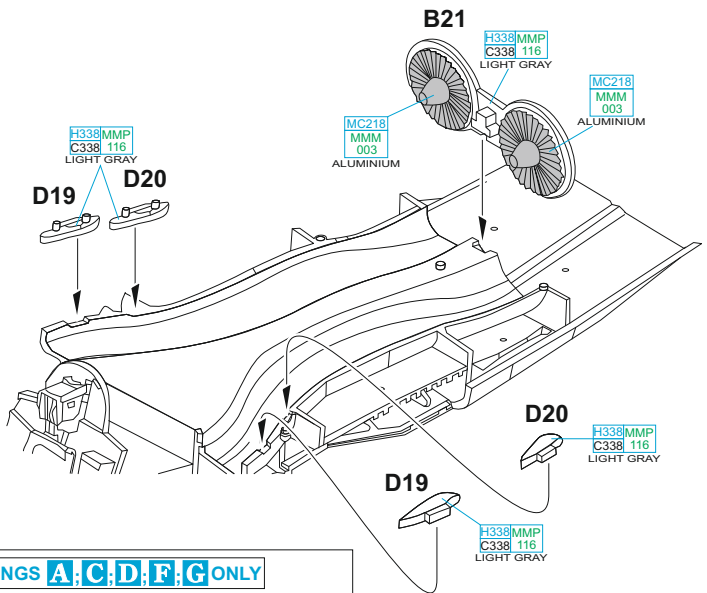
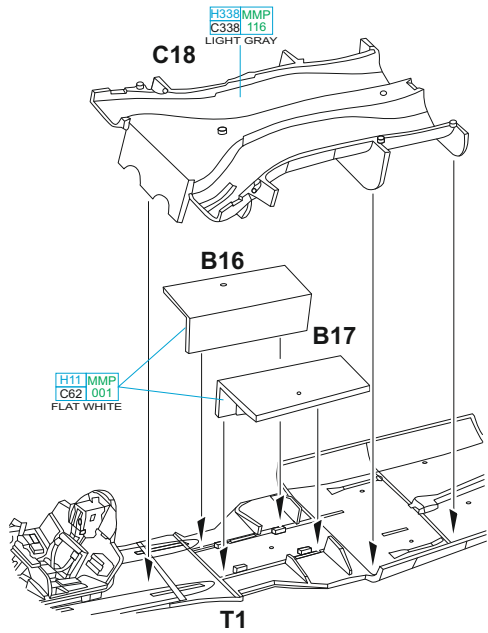

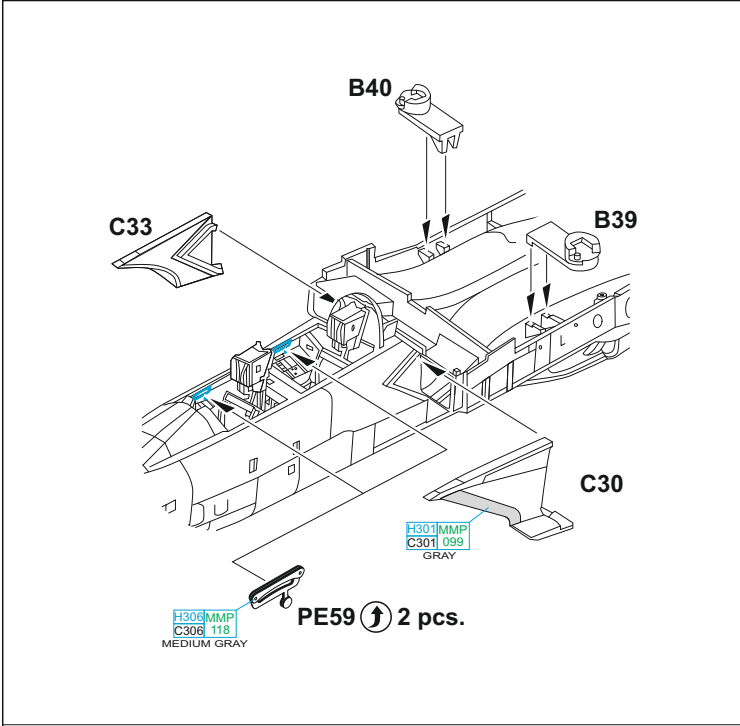

Flaps up

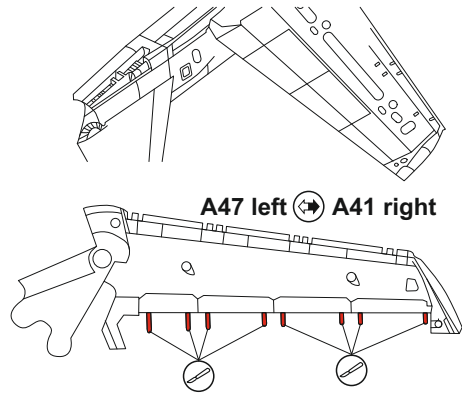

Flaps down

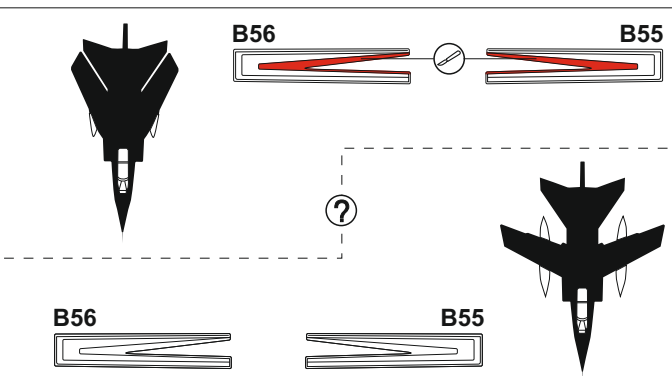
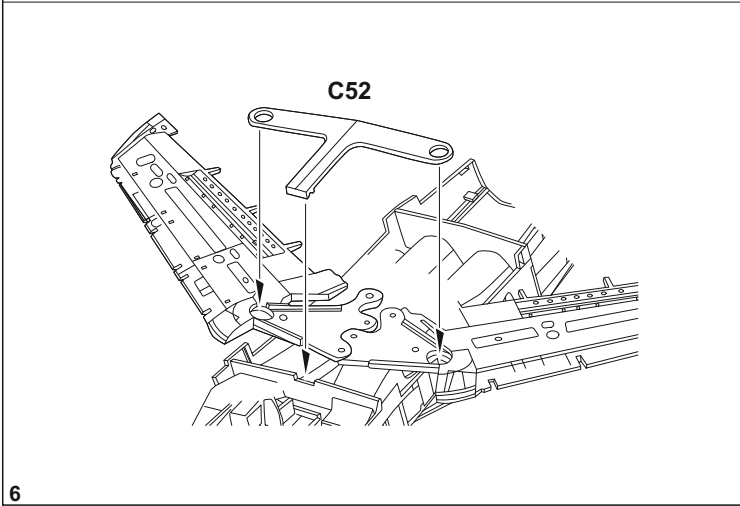
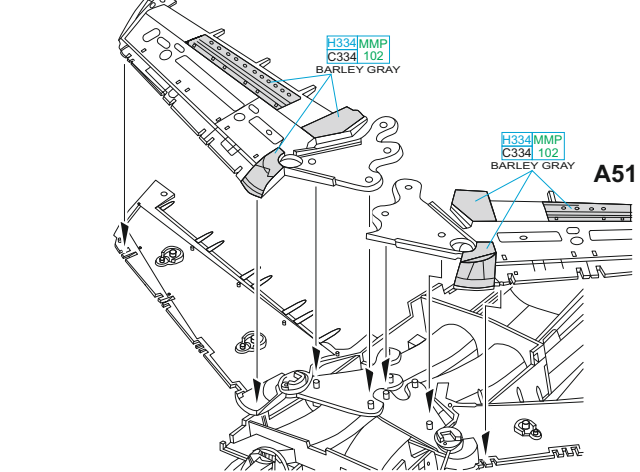
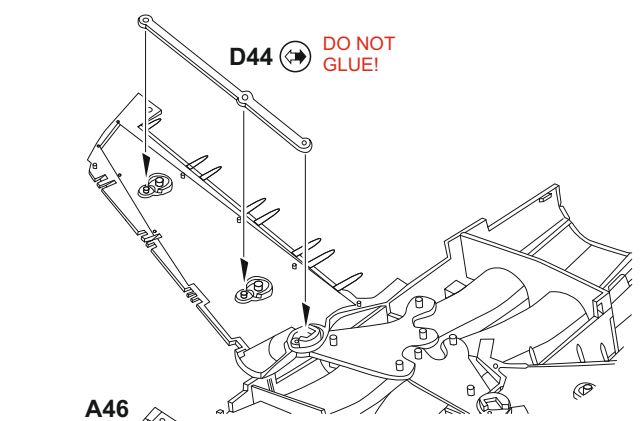
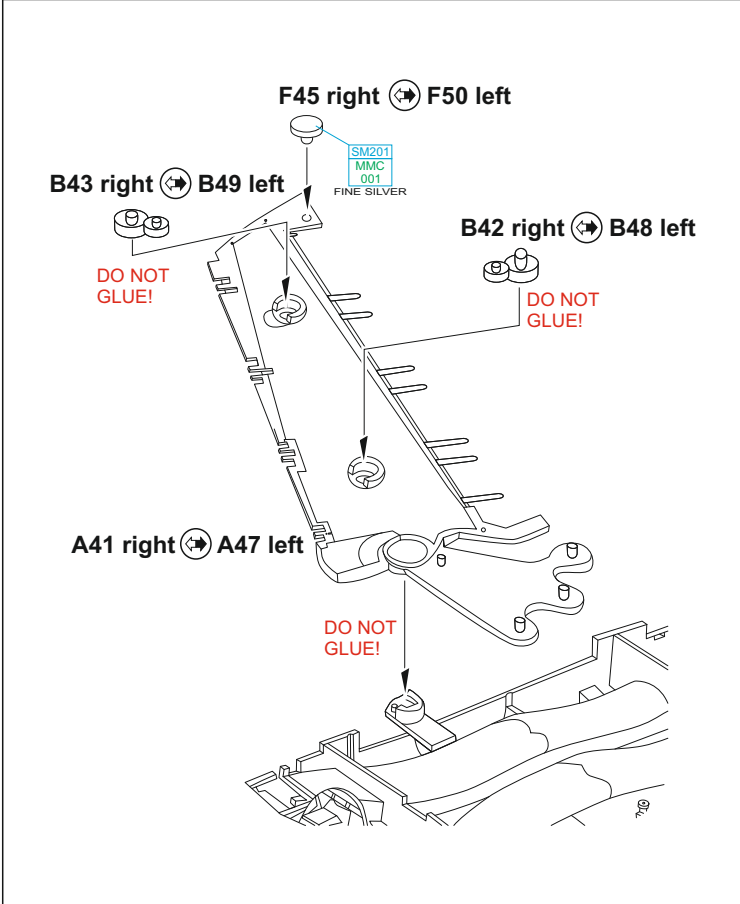
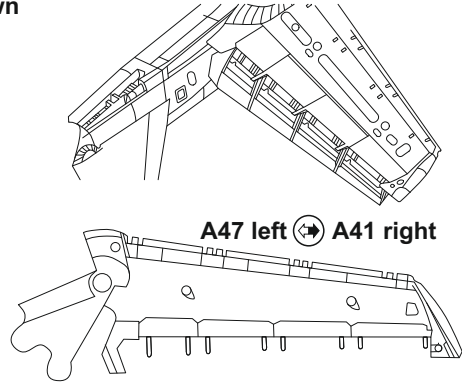

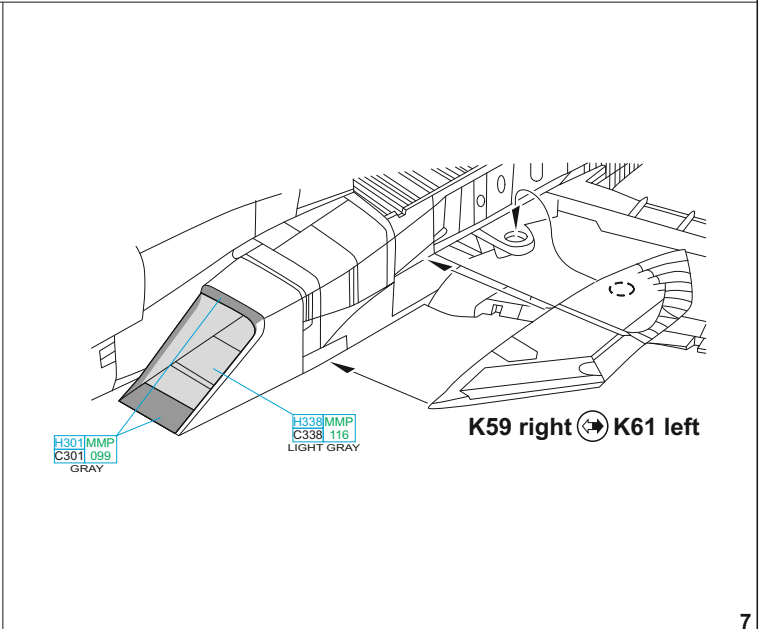
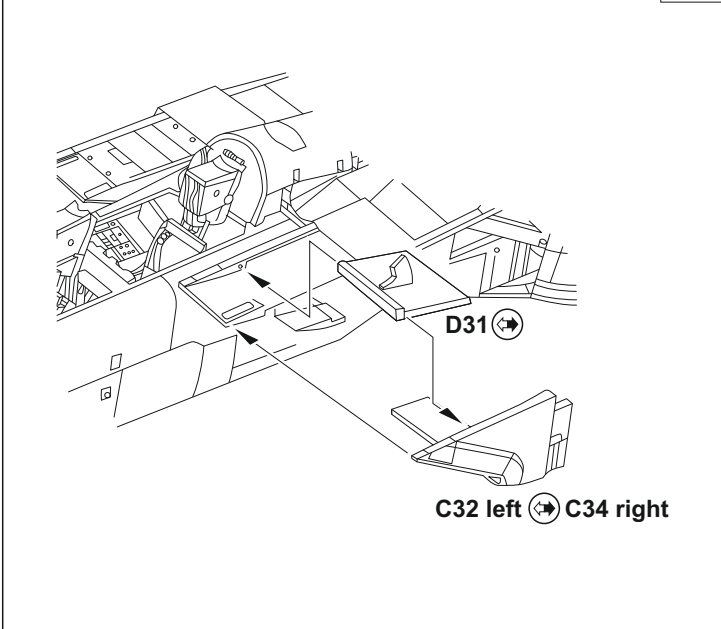
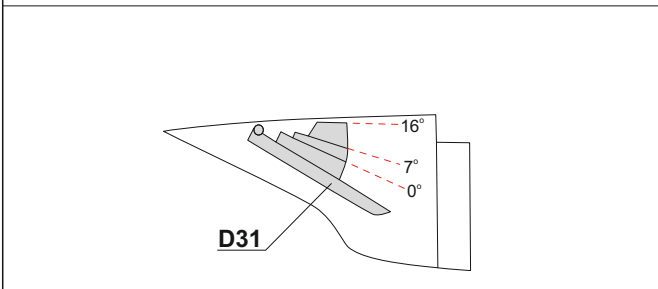
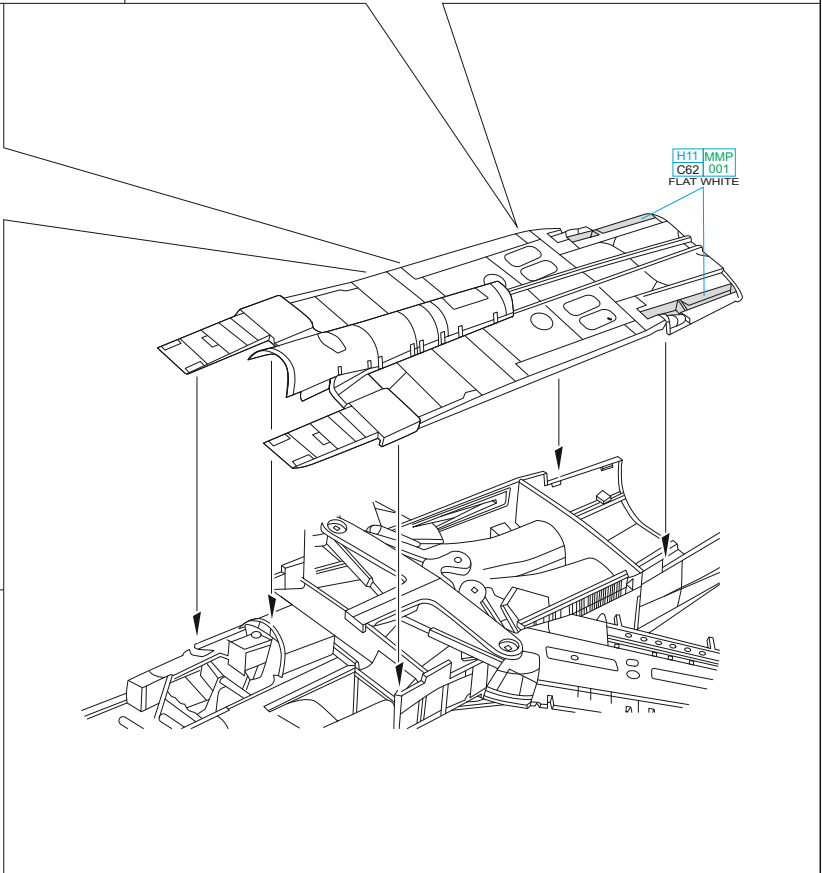
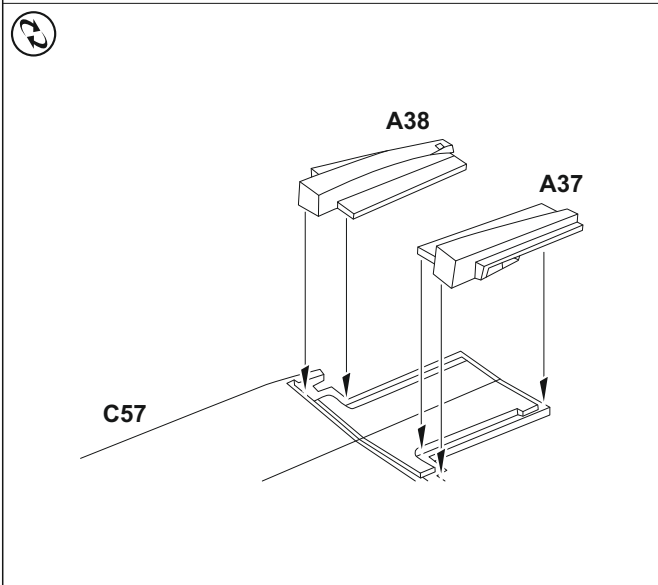
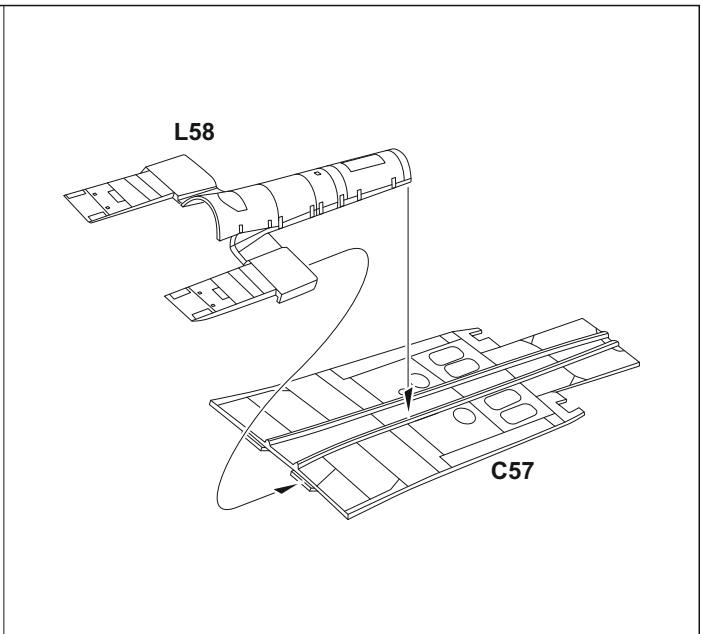
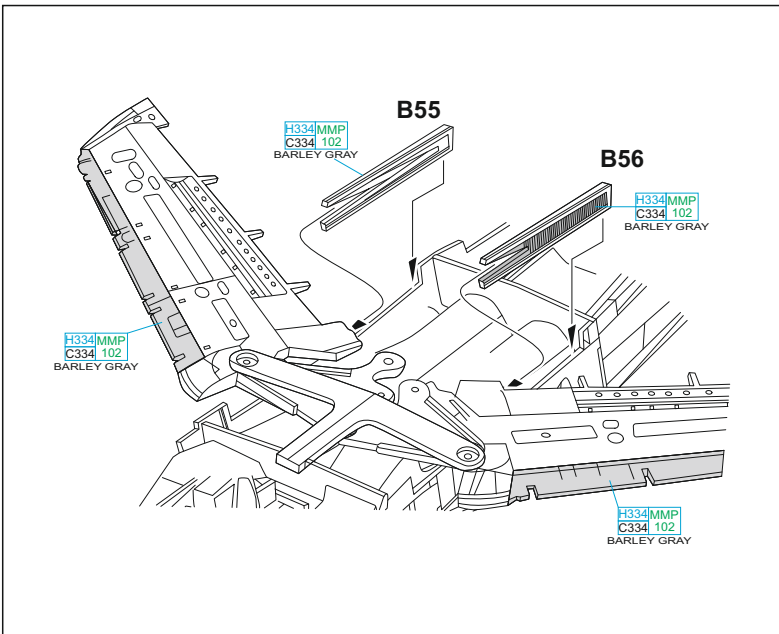

K62 left ↔ K60 right

DO NOT
GLUE!

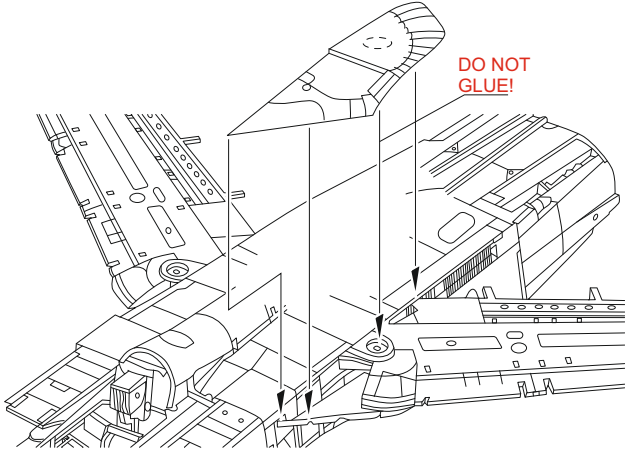

T65

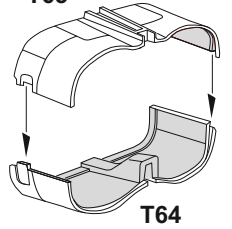

T64

DO NOT
GLUE!

E63

DO NOT
GLUE!

E63

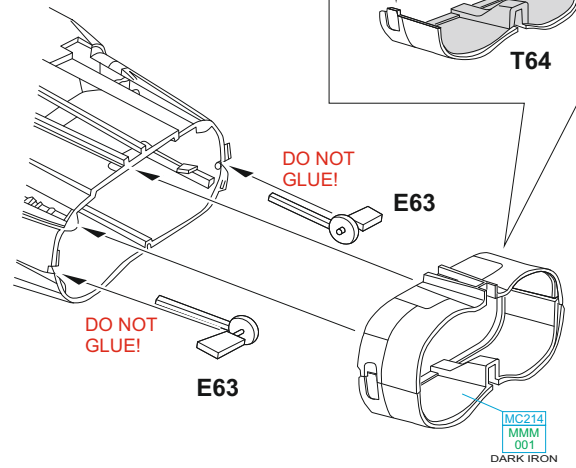

MC214
MMM
001
DARK IRON

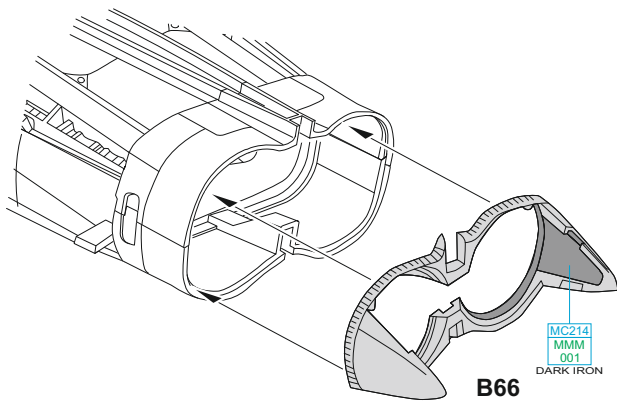

B66

MC214
MMM
001
DARK IRON

T70

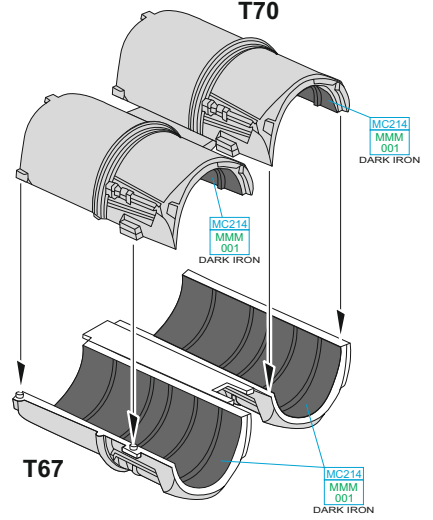

MC214
MMM
001
DARK IRON

MC214
MMM
001
DARK IRON

T67

MC214
MMM
001
DARK IRON

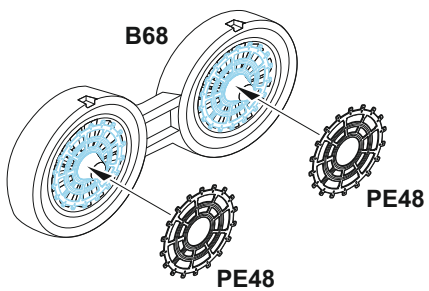

B68

PE48

PE48

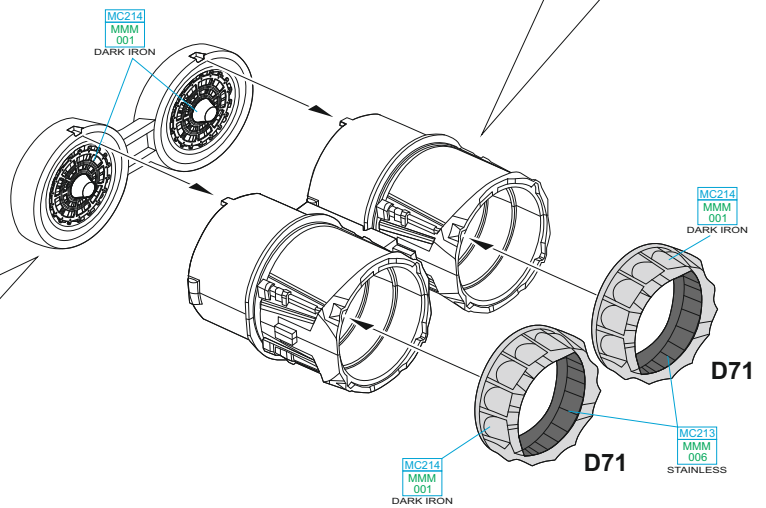

MC214
MMM
001
DARK IRON

MC214
MMM
001
DARK IRON

D71

MC214
MMM
001
DARK IRON

D71

MC213
MMM
005
STAINLESS

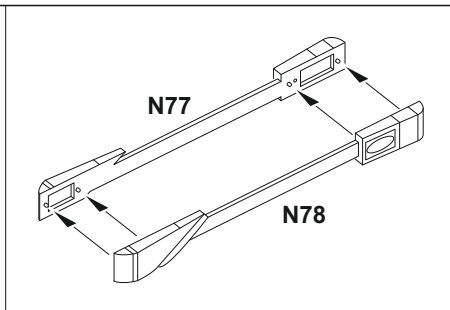
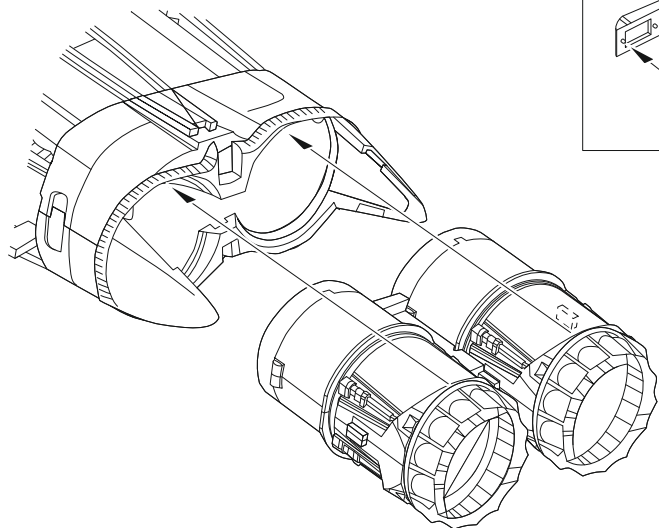

E

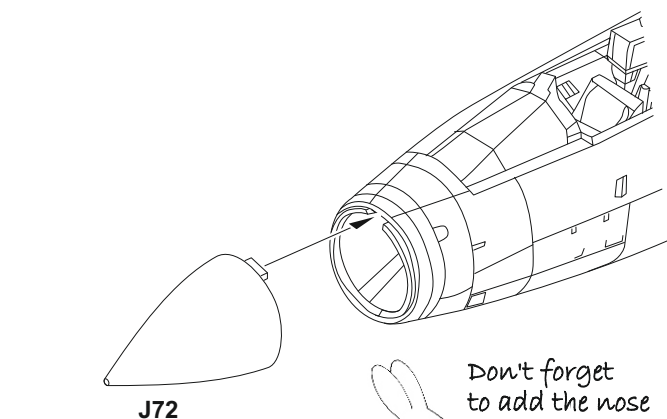
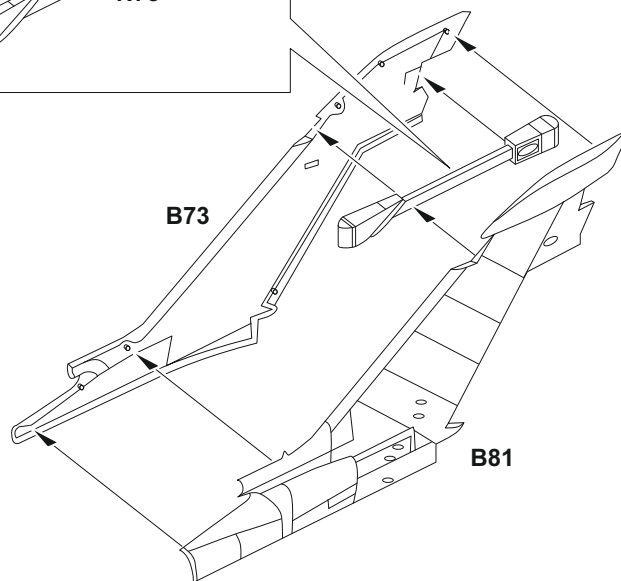

J72



Don't forget
to add the nose
weight balance!

F

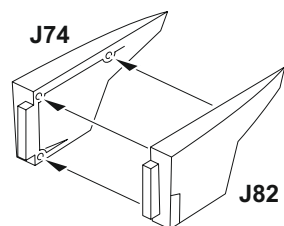

J74

J82

G

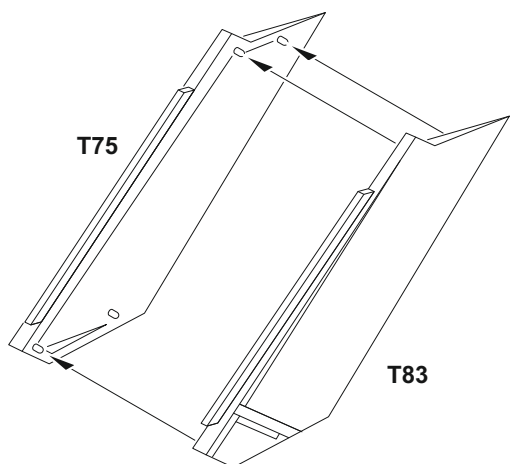

T75

T83

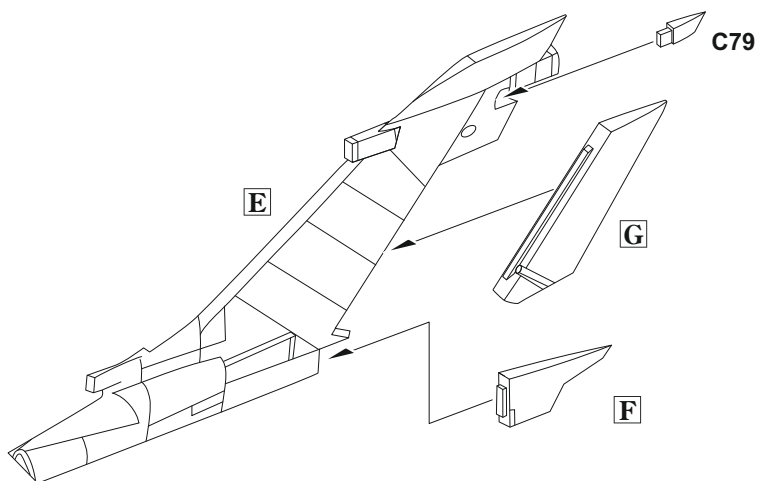

E

G

F

C79

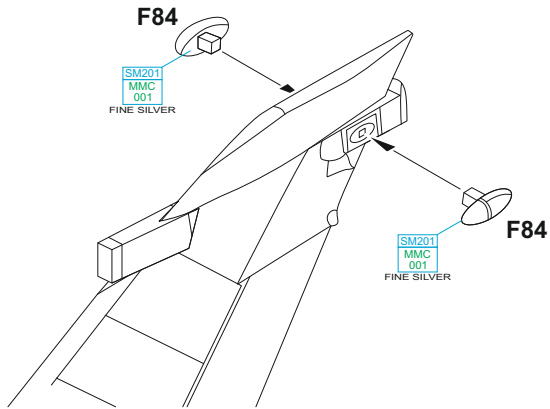

H 2 pcs.

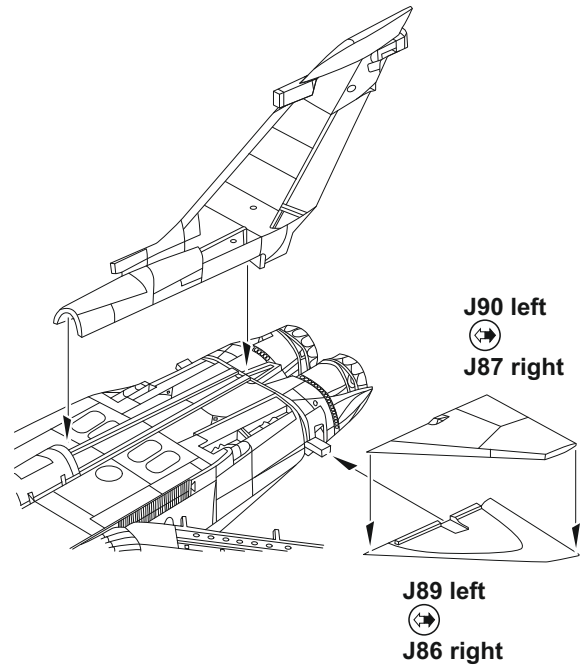
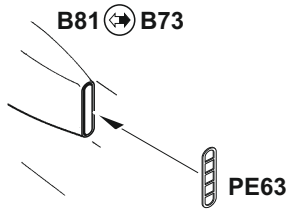

Slats up

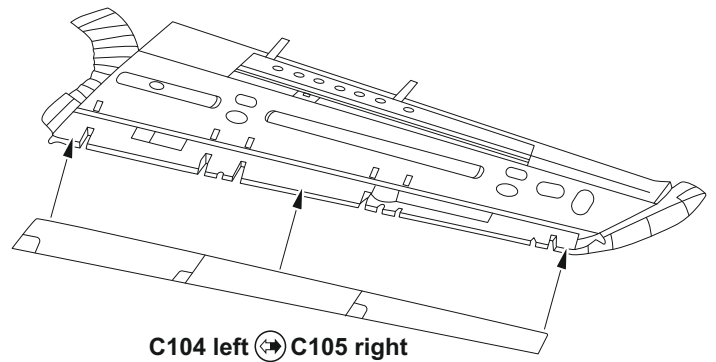

?

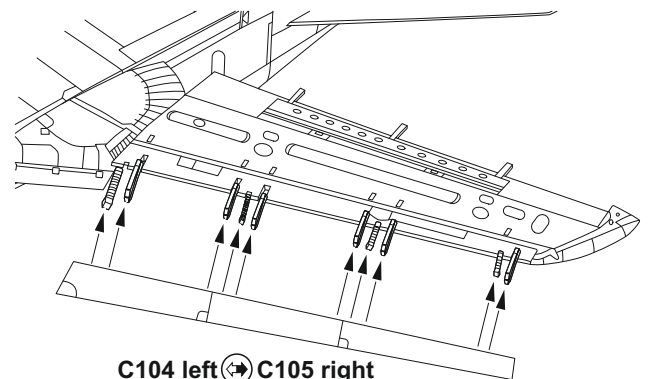

Slats down

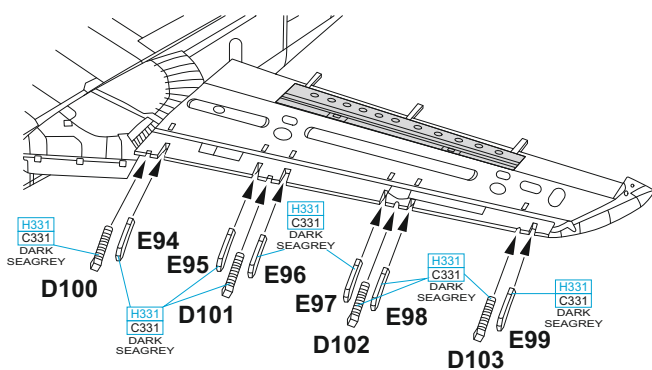

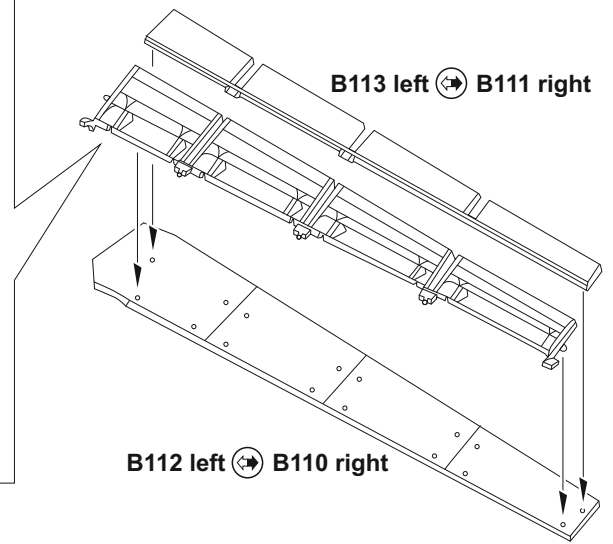
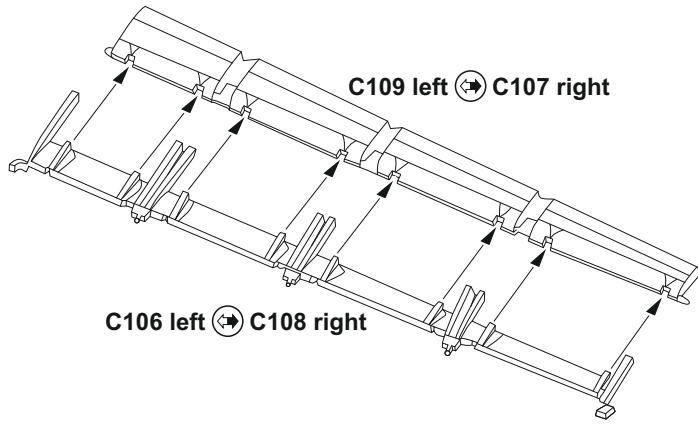

Flaps down

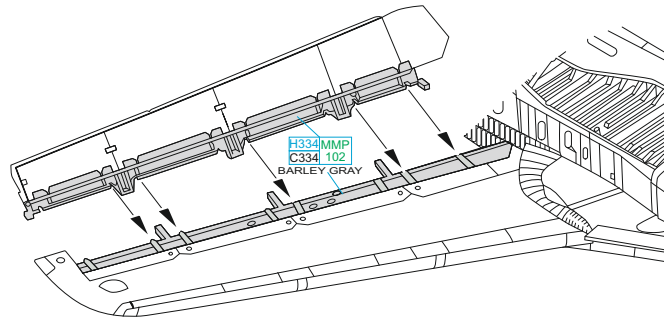

Flaps up

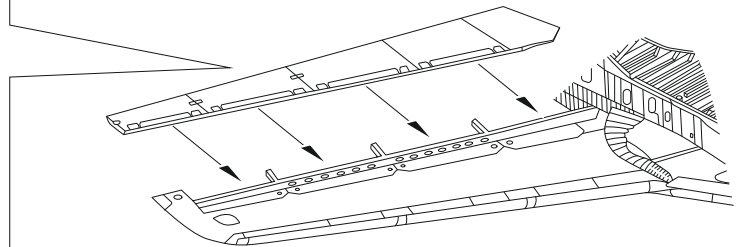
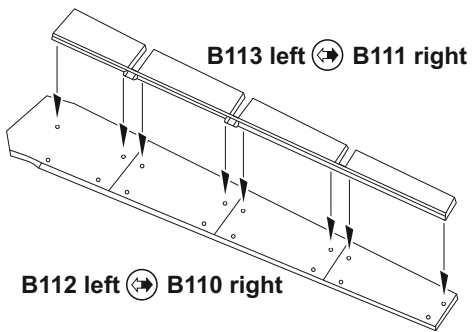

?

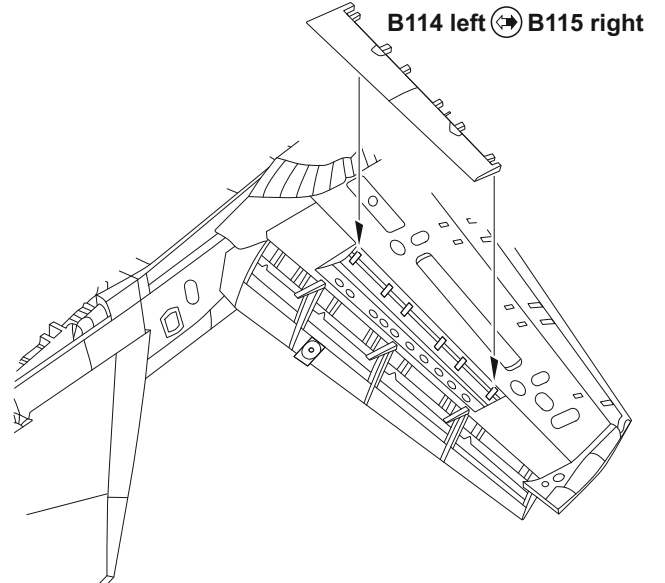
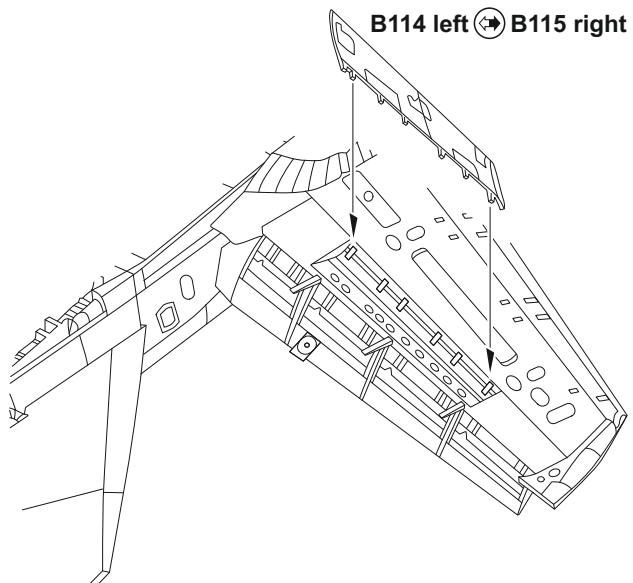

?

J

A37 right

A38 left

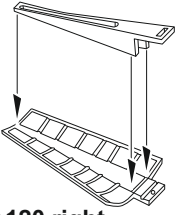

A120 right

A118 left



D117

J

**H338 MMP
C338 116
LIGHT GRAY**



**SM201
MMC
001
FINE SILVER**

J

D117

**H11 MMP
C62 001
FLAT WHITE**

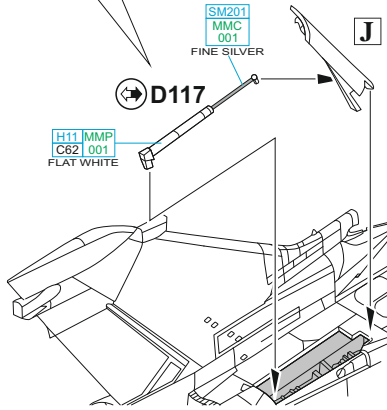

?

A120 right **A118 left**

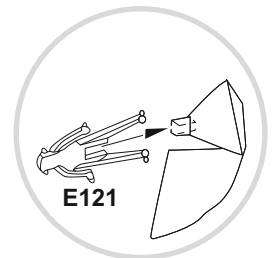
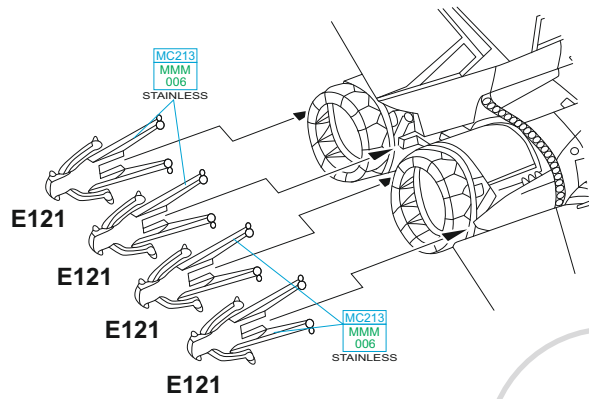
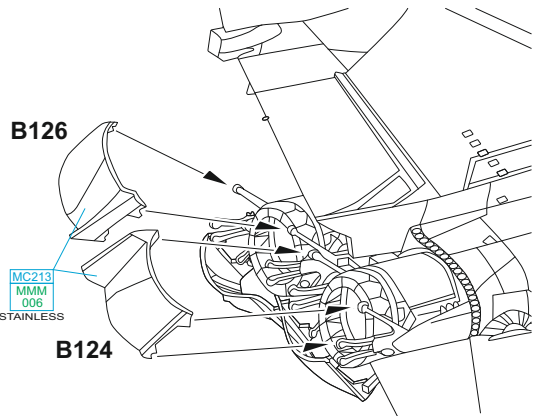
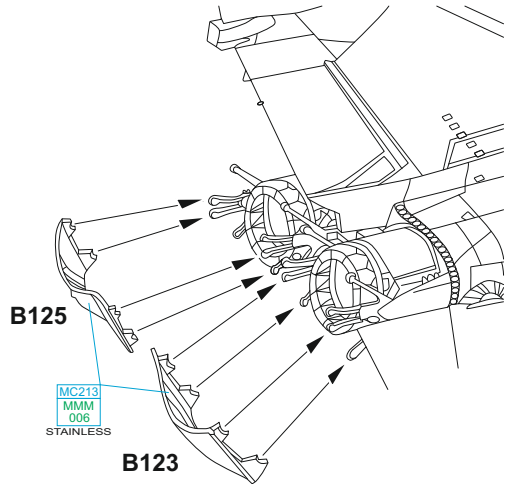
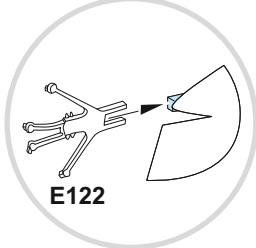
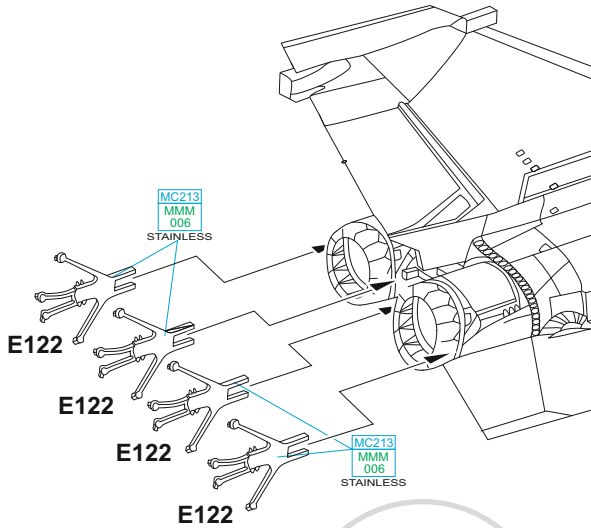
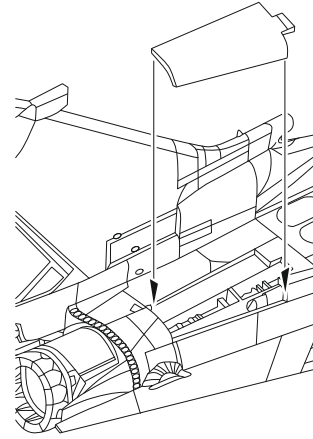

?

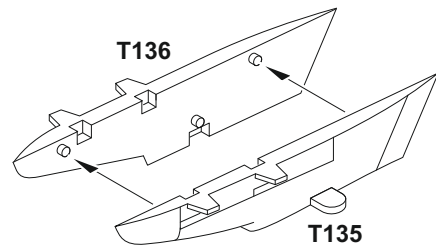
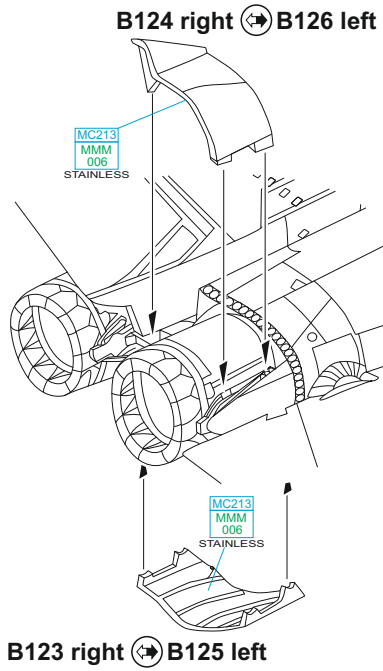
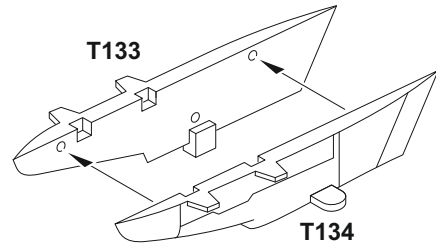
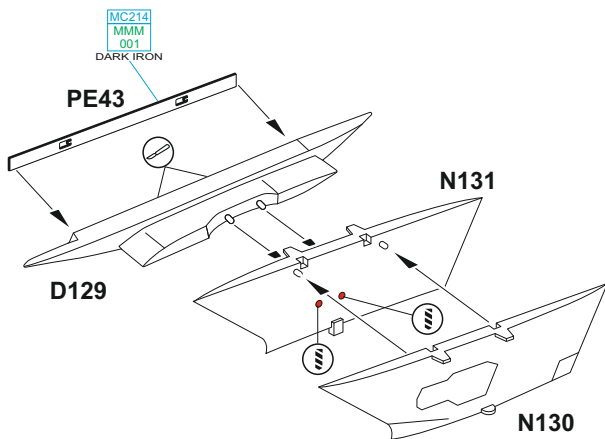
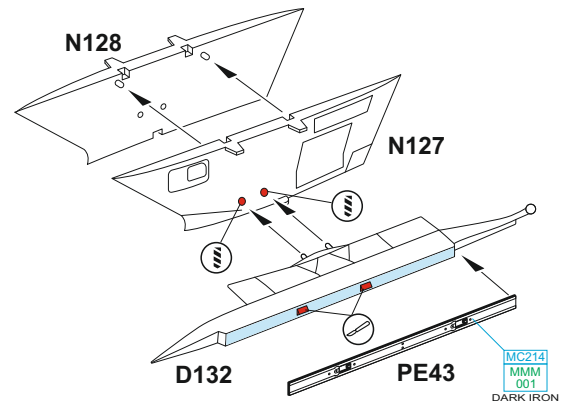
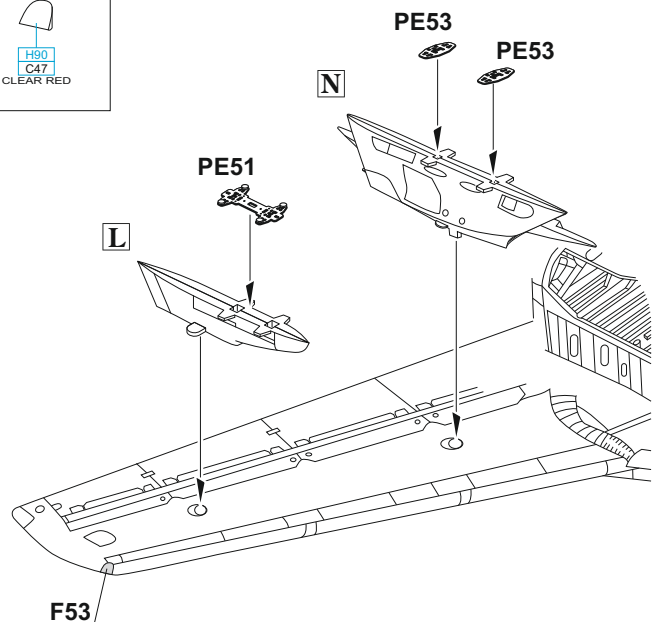
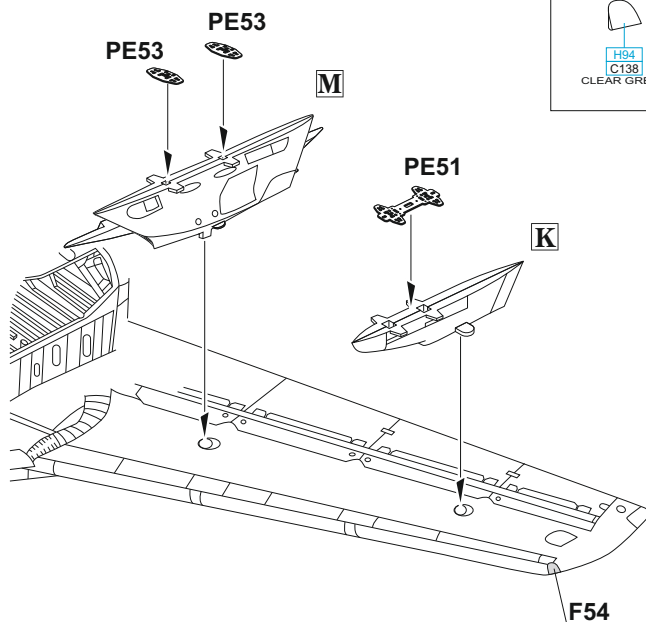
K**L****M****N****F54****F53**

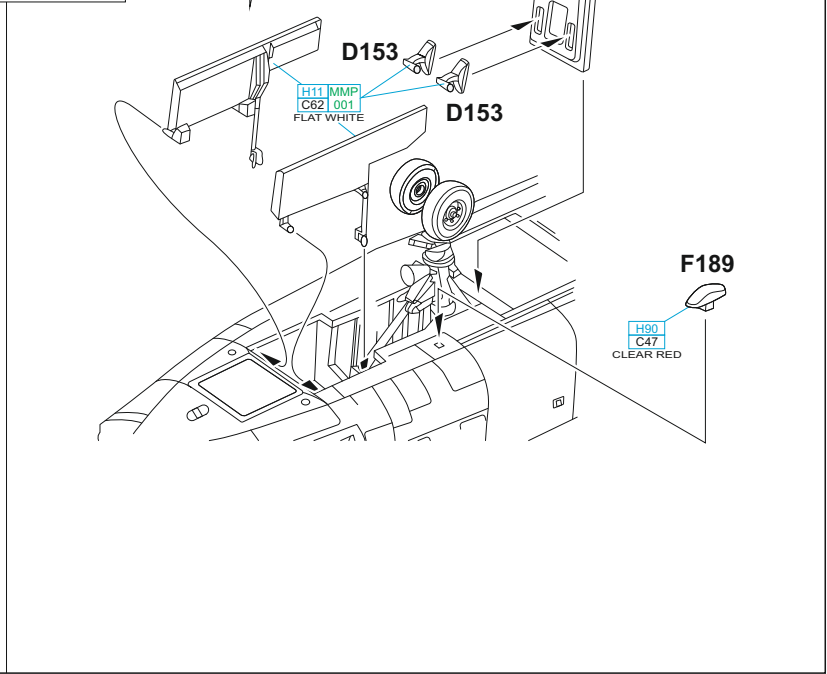
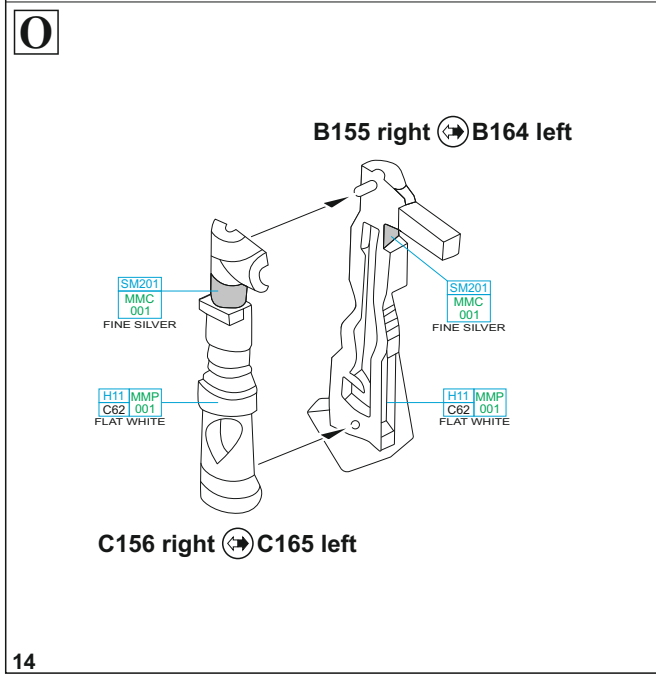
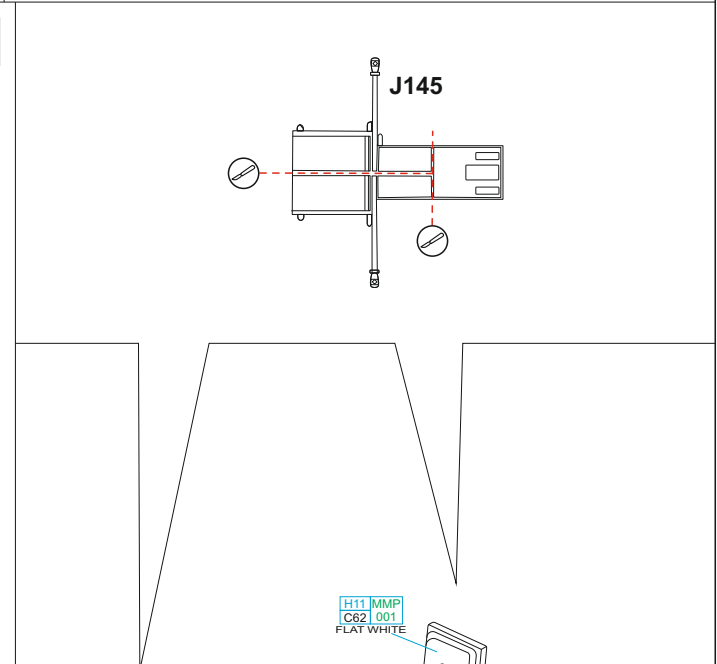
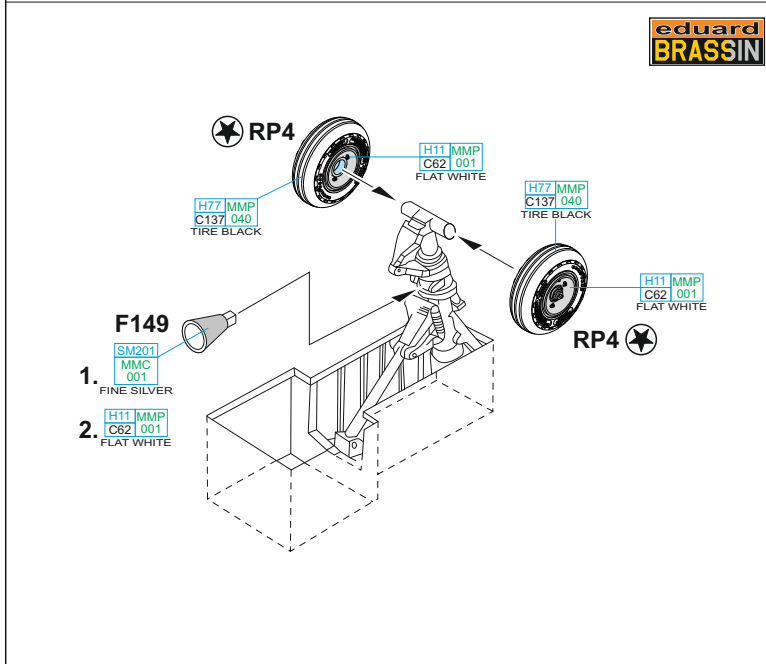
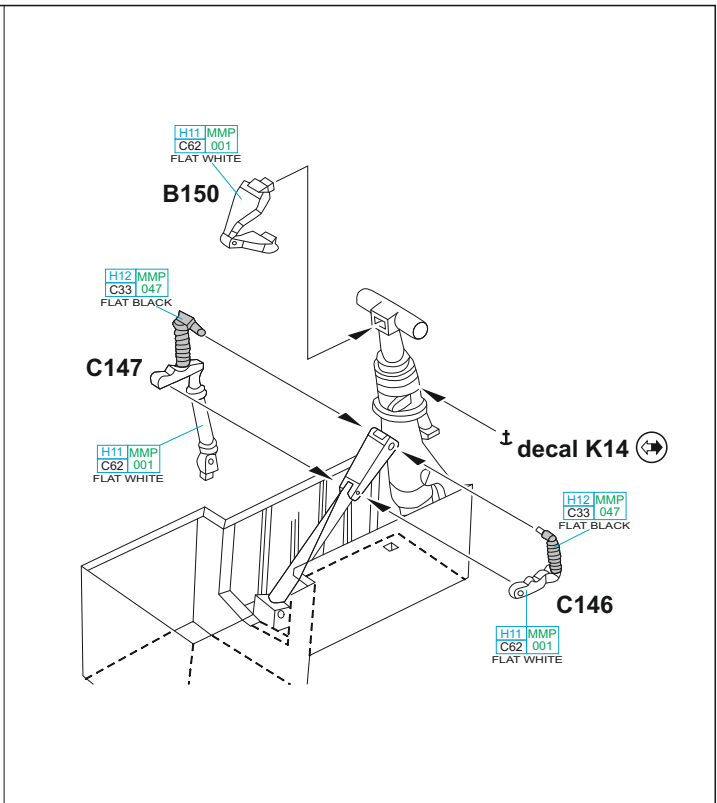
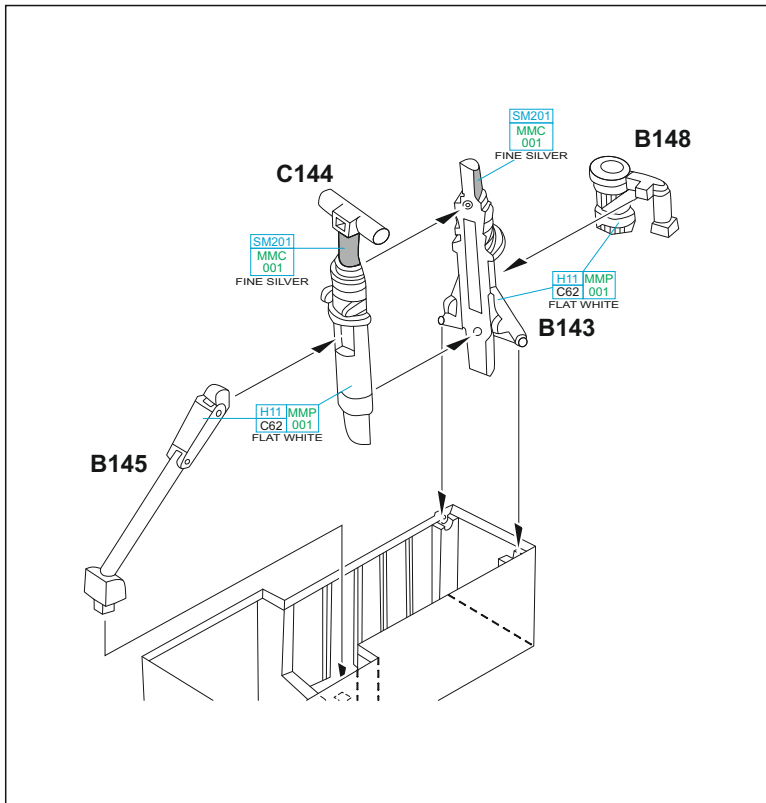

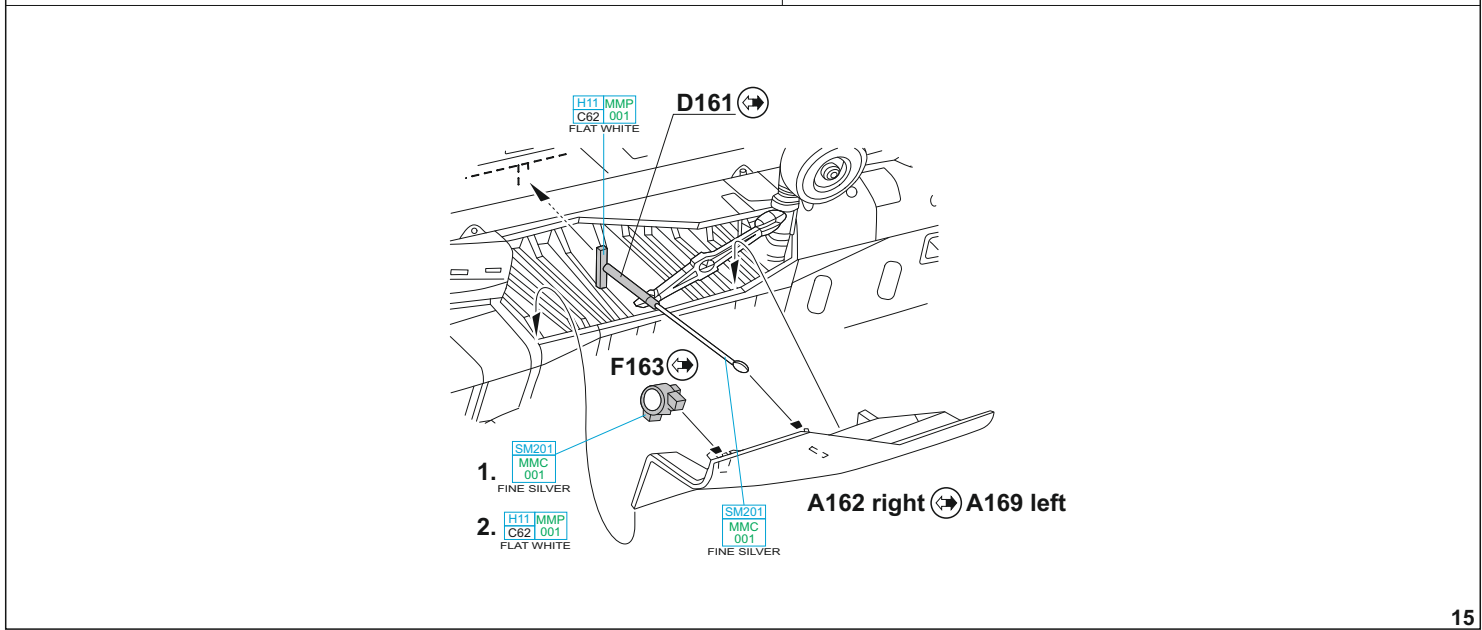
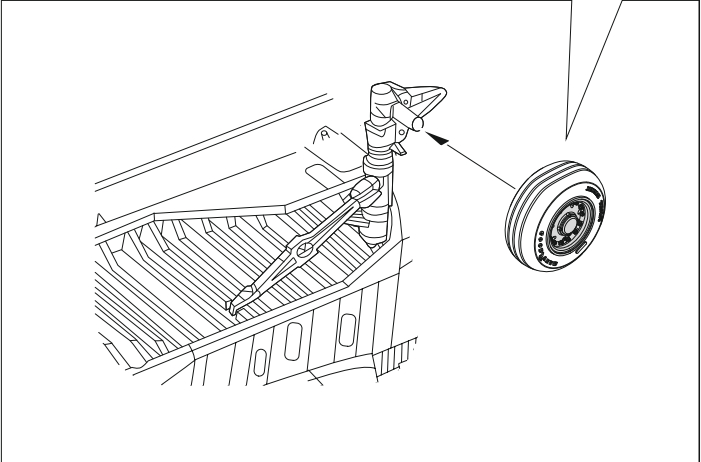
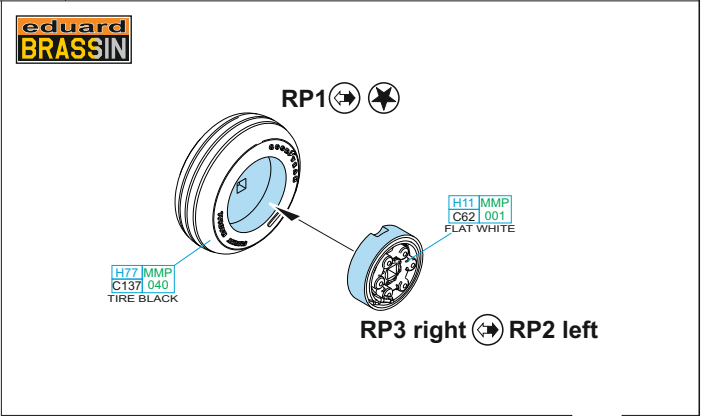
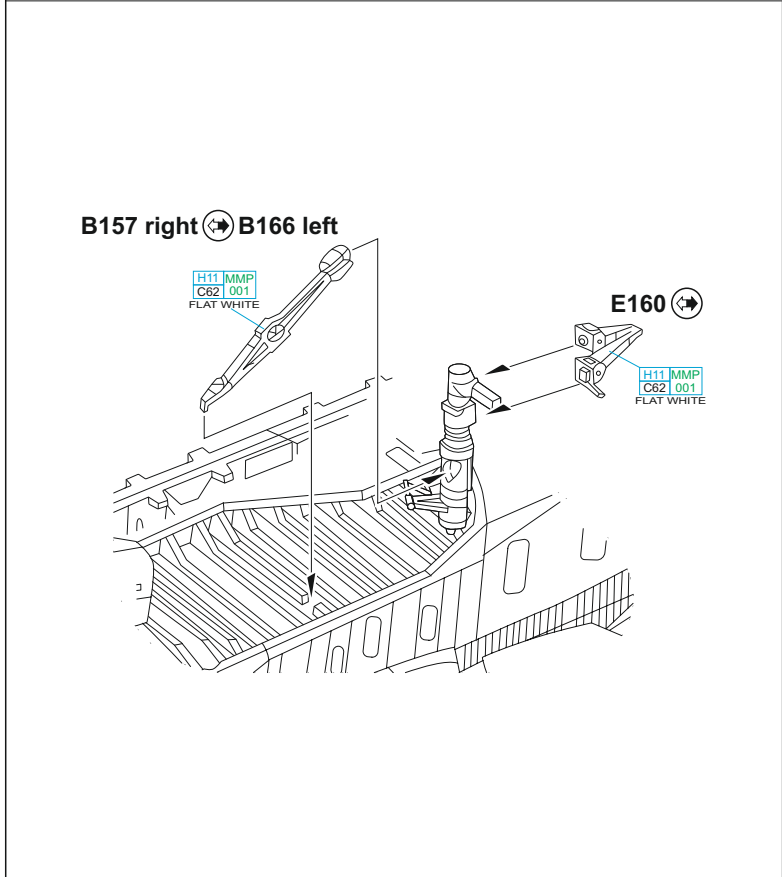
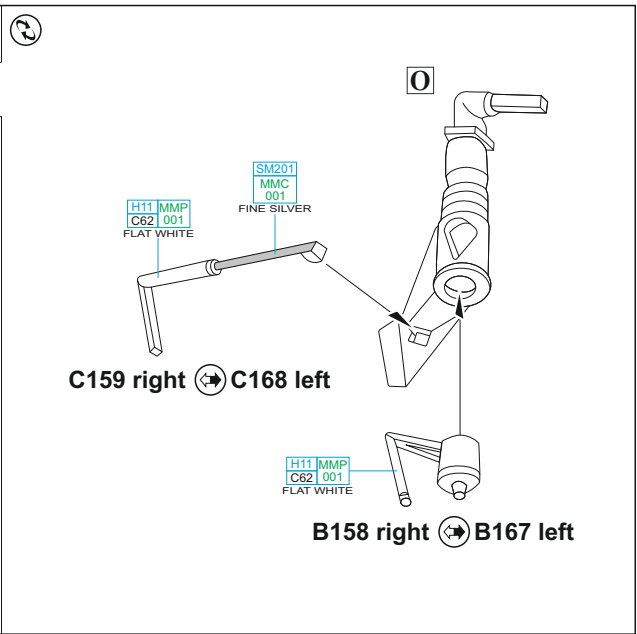
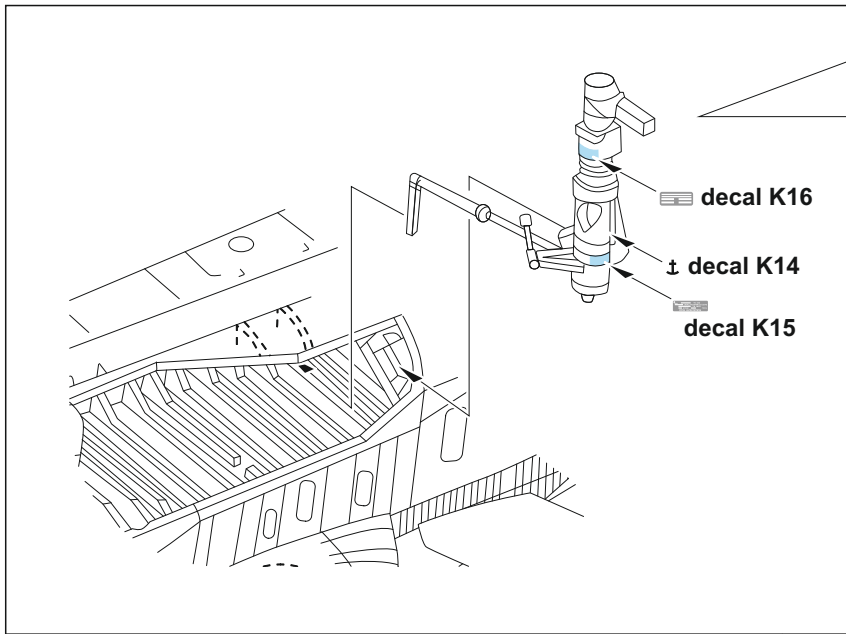

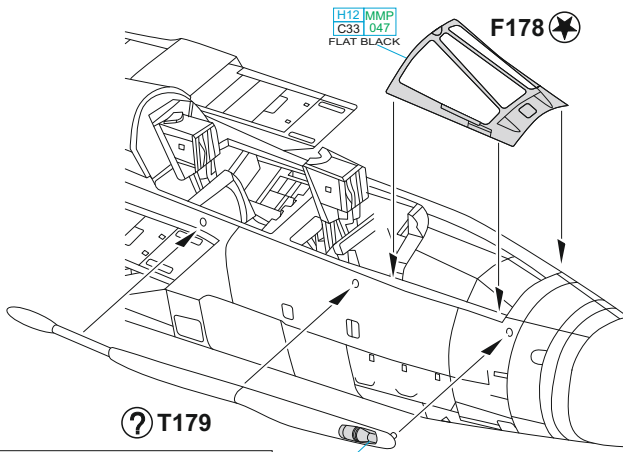

T179 - MARKINGS **A, C, D, F, G** ONLY

SM201 MMC 001 FINE SILVER

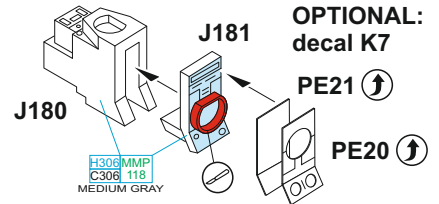

OPTIONAL:
decal K7

PE21 ↑

PE20 ↑

2 pcs.

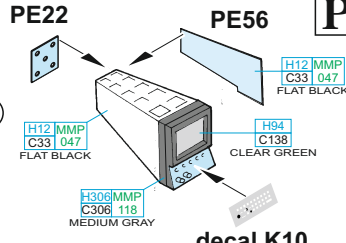
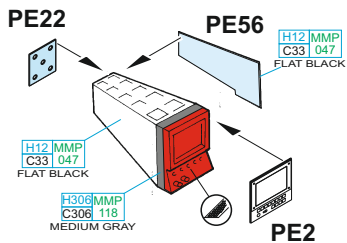
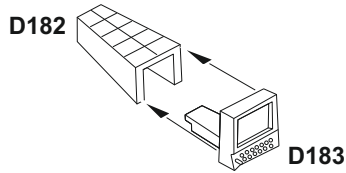

decal K10

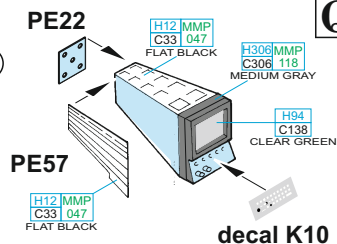
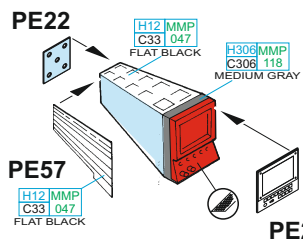

decal K10

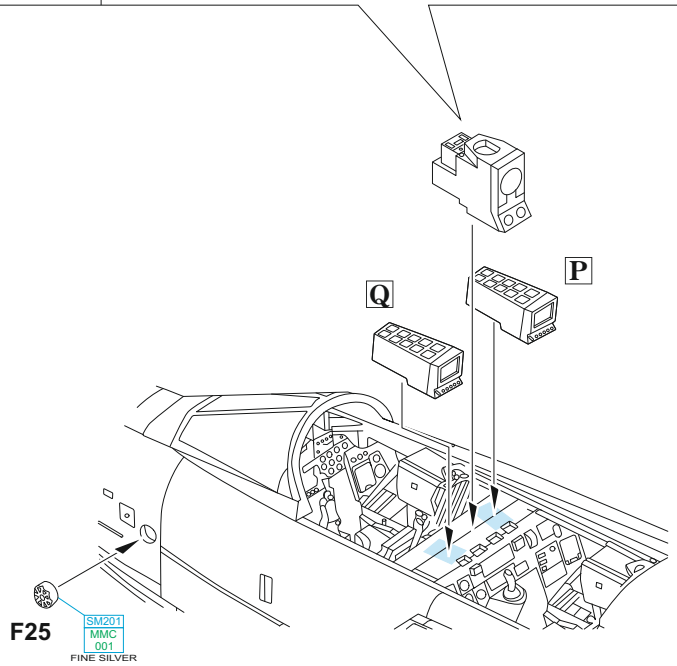

F25 SM201 MMC 001 FINE SILVER

OPEN CANOPY

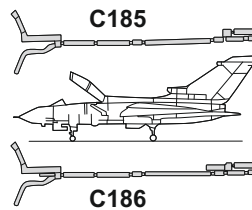

CLOSED CANOPY

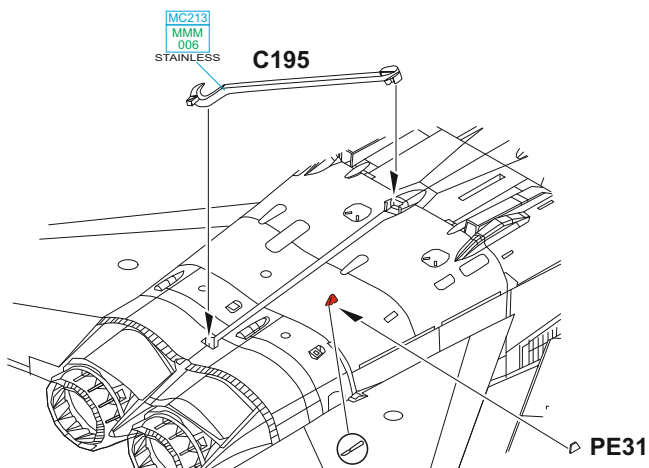
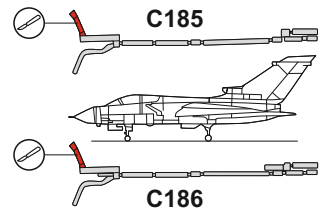

MC213 MMM 006 STAINLESS

C195

PE31

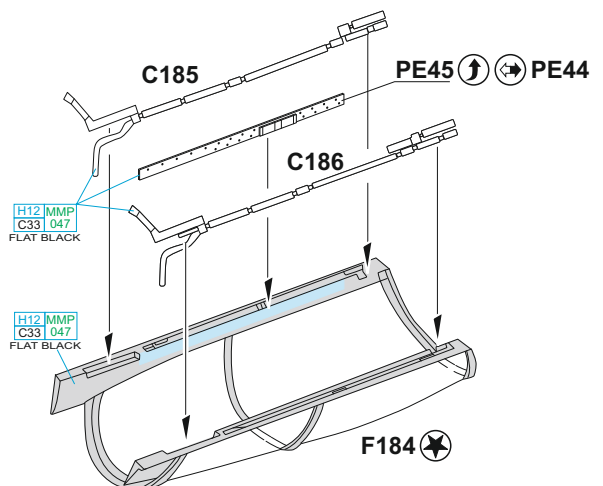

C185

PE45 ↑

PE44 →

C186

H12 MMP C33 047 FLAT BLACK

H12 MMP C33 047 FLAT BLACK

F184

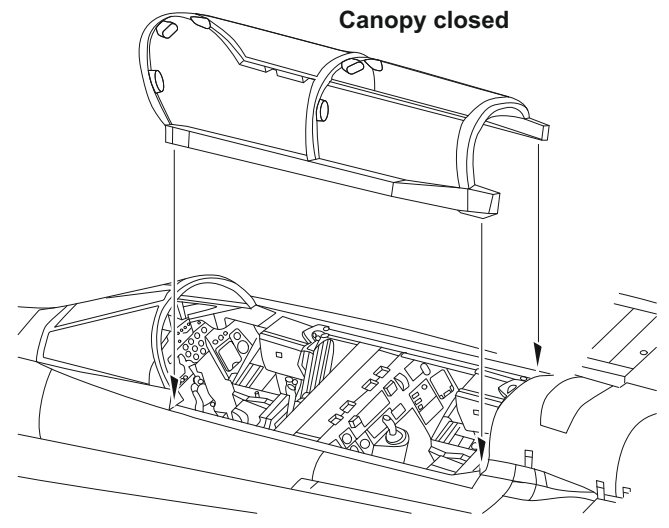
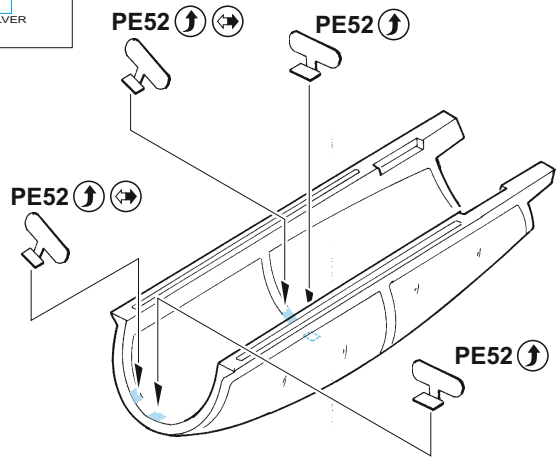
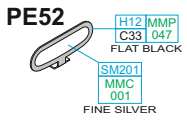

?

Canopy open

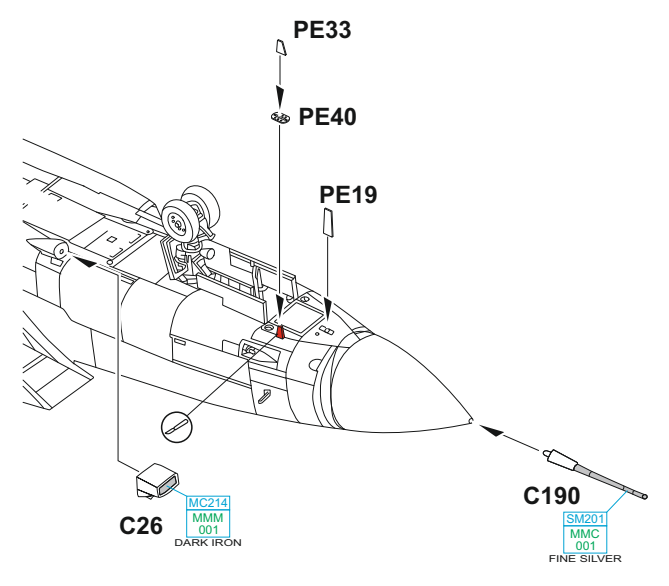
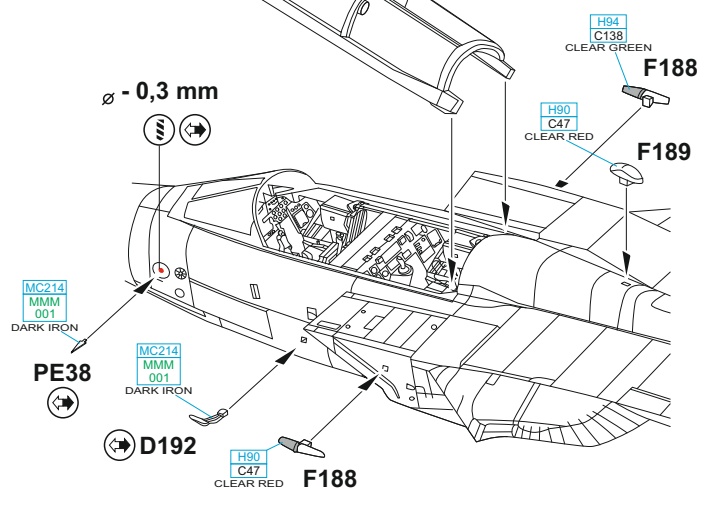

R ?

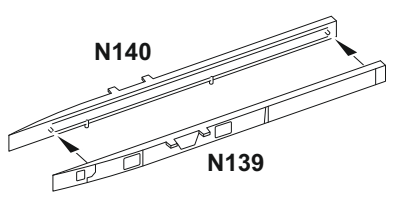

S

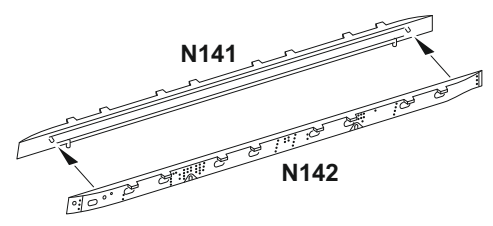

T

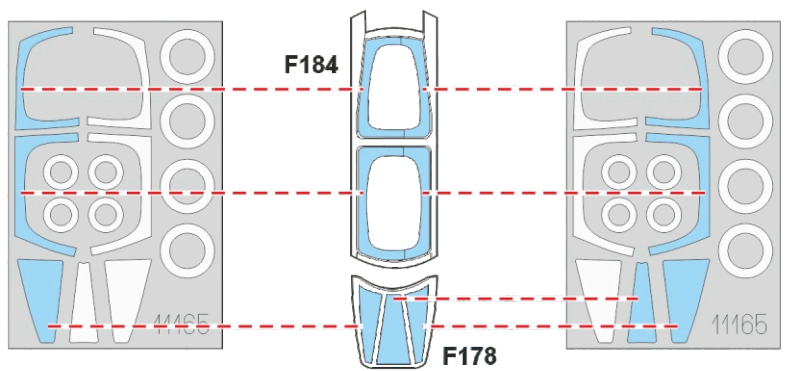
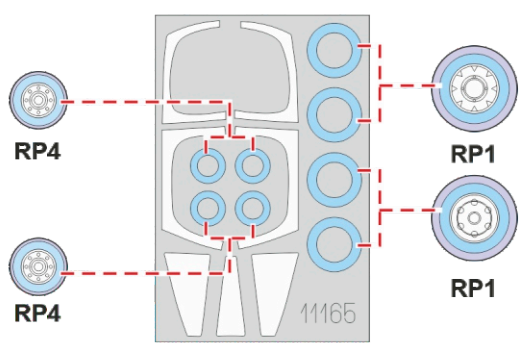
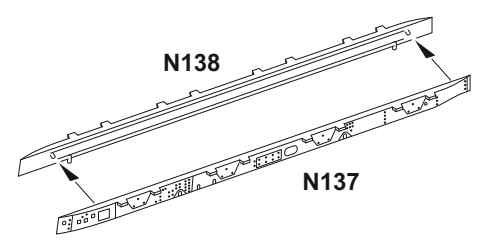

U ? 2 pcs.

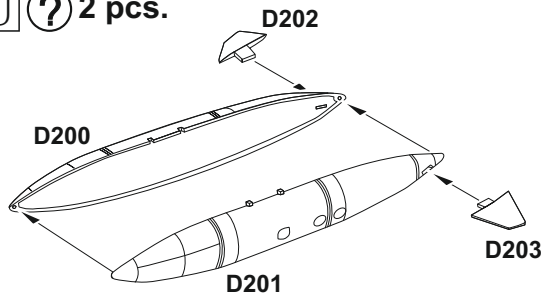

3 pcs
PE61

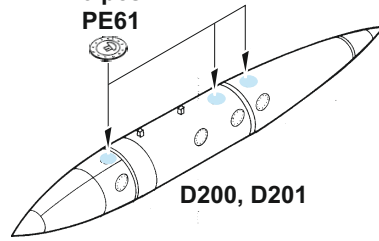

V MARKINGS **C, F** ONLY

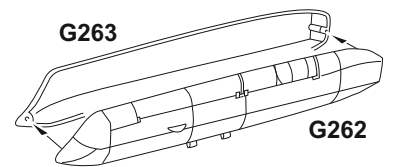

? MARKINGS **C, F** ONLY

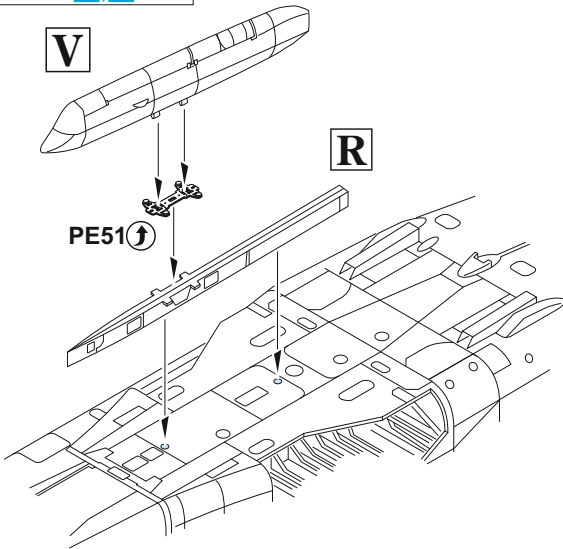

?

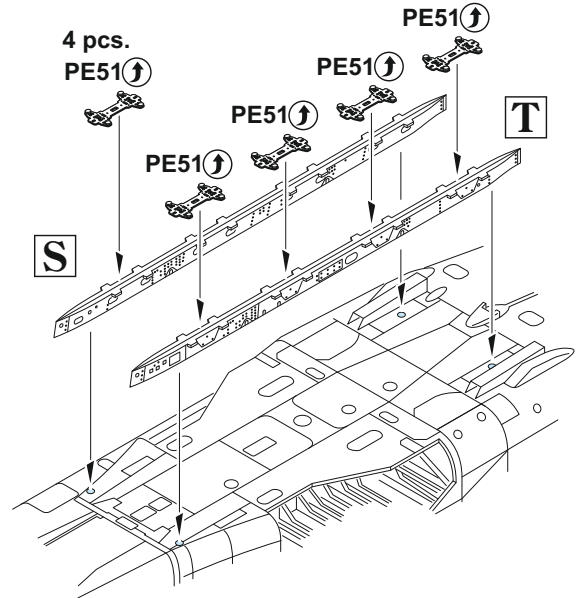

W ? 2 pcs.

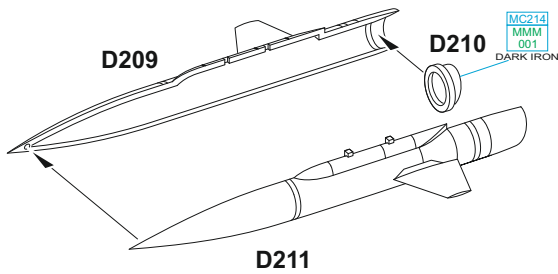

X ? MARKINGS **E, F** ONLY

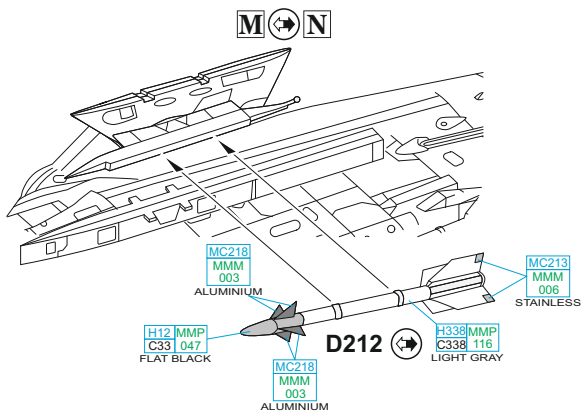
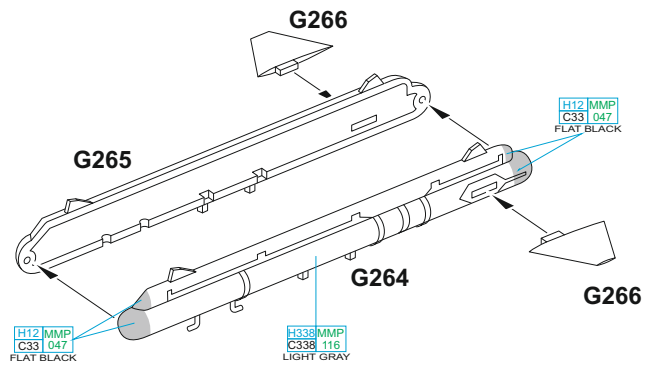

W ? **X**

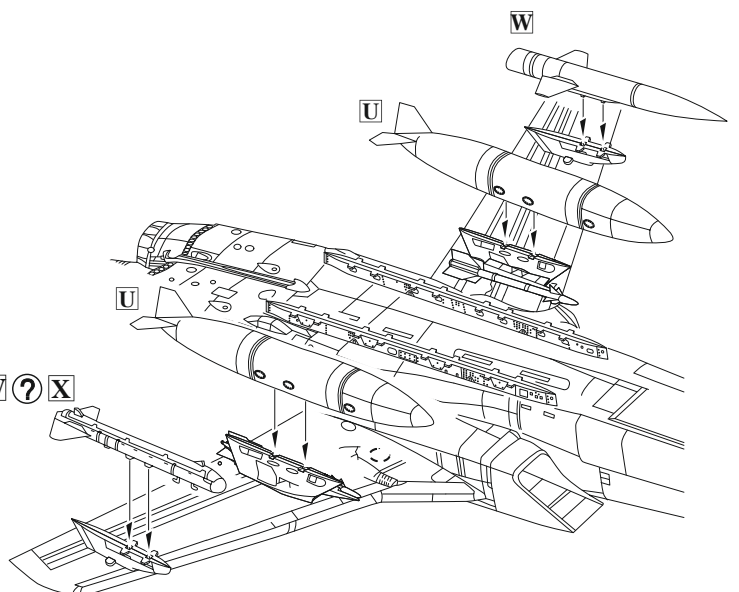

A MFG 2, letecká základna Eggebek, Německo, 2002-2004

Letoun Panavia Tornado IDS s kódovým označením 46+20 z jednotky Marinefliegergeschwader 2 byl v tomto pestrém zbarvení používán coby předváděcí letoun v letech 2002 až 2004. Jednotka MFG 2 byla jako poslední stíhací křídlo německého námořnictva rozpuštěna v roce 2005. Tornado 46+20 má pod znakem MFG 2 na směrovém kormidle vyobrazen znak obnoveného Aufklärungsgeschwader 51 (AG 51) „Immelmann“ (51. průzkumné křídlo). Tato jednotka byla vybavena letouny Tornado a převzala také část úkolů MFG 2. Kamufláž Tornada IDS 46+20 je provedena podle tzv. Norm 87.



NAVY BLUE	H54 MMP C365 065	GREEN	H309MMP C309 031	DARK GRAY	H68 MMP C36 049	CLEAR RED	H90 MMP C47 167
FLAT BLACK	H12 MMP C33 108	CLEAR GREEN	H94 MMM C138 169	GRAY	H308MMP C308 073	CHROME SILVER	MC211 MMC 001
							BARLEY GRAY
							H334MMP C334 102

B JaboG 38, letecká základna Jever, Německo, 1986

Jednotka Jagdbombergeschwader 38 sídlila na severu v dolnosaském Jeveru. Byla založena v srpnu 1983 a do výzbroje dostala víceúčelové stroje Tornado IDS. Tornady ECR byla vybavena její 2. Staffel v roce 1989 a používala je až do roku 1995, kdy byla Tornado v provedení ECR odeslána k JaboG 32. Dne 31. srpna 2005 byla JaboG 38 rozpuštěna. Kamufláž Tornada IDS 43+22 je provedena v tzv. Norm 76.

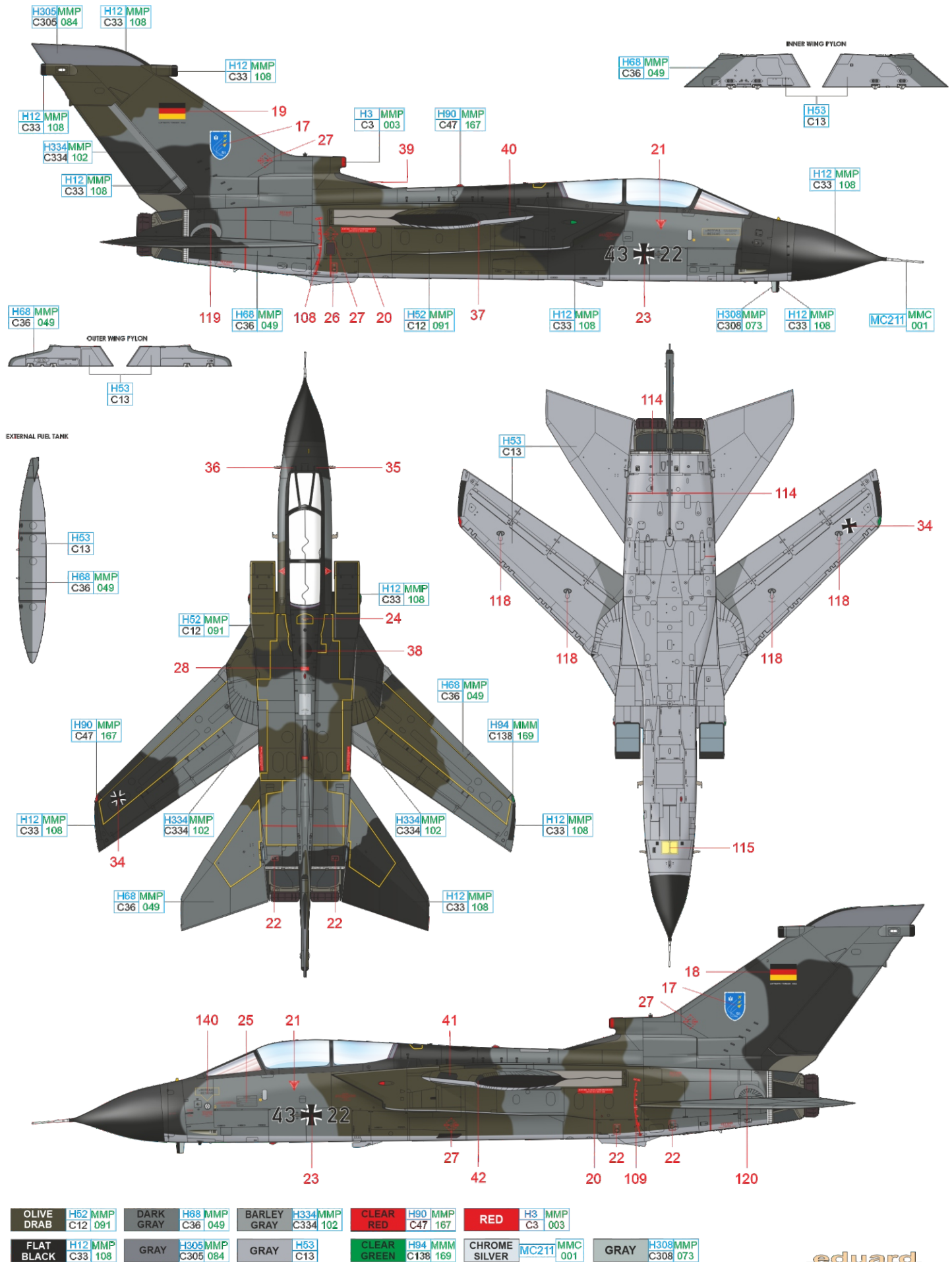

C AG 51 „Immelmann“, letecká základna Schleswig-Jagel, Německo, 2002–2003

Aufklärungsgeschwader 51, předchůdce TaktLwG 51, byla obnovena v lednu 1994. Předchozí AG 51 byla společně se sesterskou AG 52 (obě byly vyzbrojeny průzkumnými RF-4E) rozpuštěna v polovině roku 1993. Nově vzniklá AG 51 obdržela Tornada IDS doplněná o verzi ECR. Kamufláž Tornada s označením 43+46, nastříkaná v tzv. Norm 95 třemi odstíny šedé barvy, byla z důvodu účasti na NATO Tiger Meet 2002, konané na portugalské letecké základně Beja (Base Aérea n.º 11/Base Aérea de Beja), doplněna o tygří zbarvení.



D MFG 1, letecká základna Schleswig-Jagel, Německo, 1993

Křídlo německého námořnictva Marinefliegergeschwader 1 (MFG 1) existovalo v letech 1959 až 1993 a v roce 1981 bylo vybaveno novým stíhacím letounem Tornado v počtu 57 kusů. Do té doby používalo americké Starfighter. Po skončení studené války a sjednocení Německa bylo rozhodnuto o snížení počtu jednotek Bundeswehru. MFG 1 byla jednou z mnoha „obětí“ tohoto vývoje a 31. prosince 1993 byla rozpuštěna. Druhá letka MFG 1 byla začleněna do MFG 2. Kamufláž Tornada IDS 43+87 byla provedena v tzv. Norm 76.

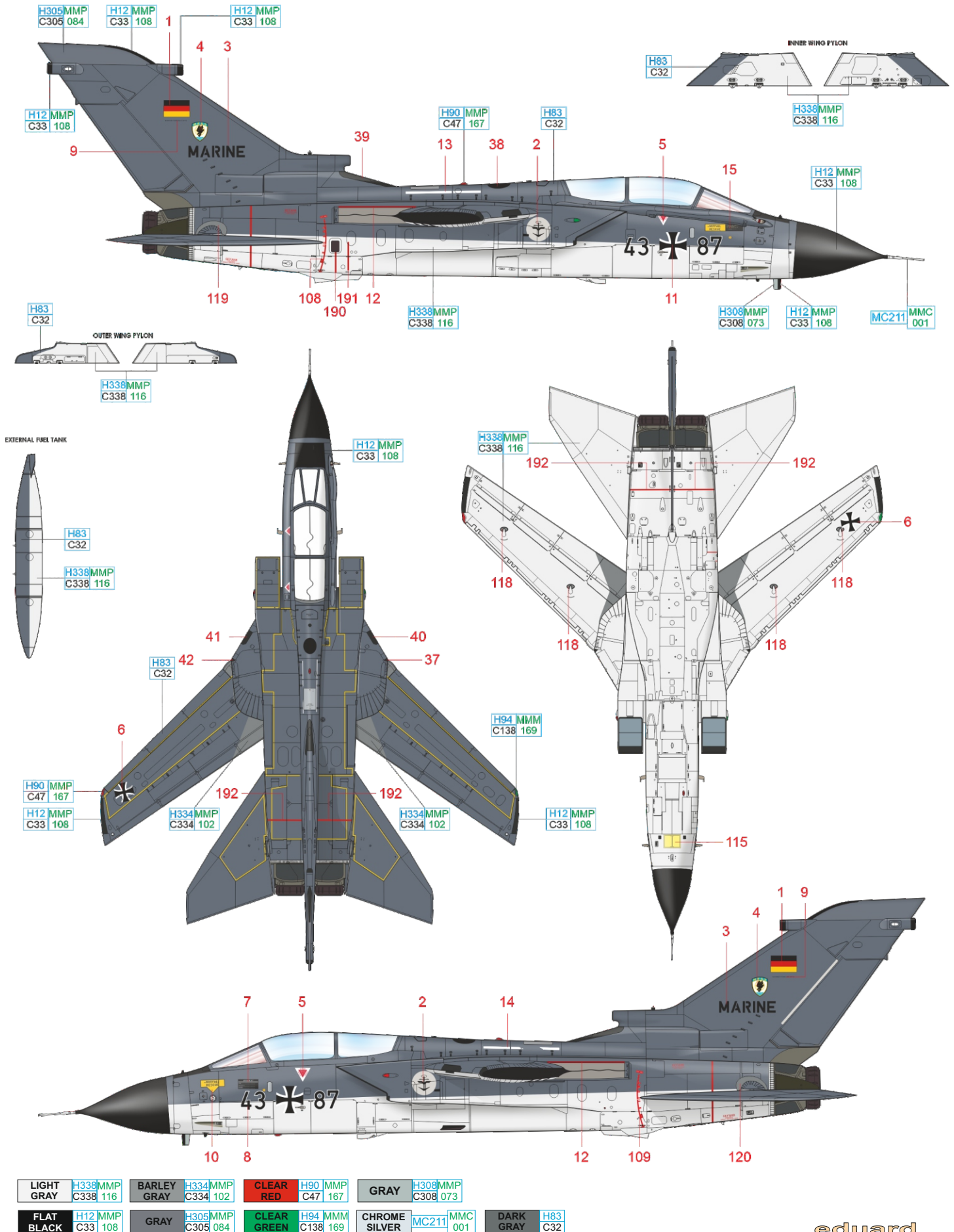

E JaBoG 31, letecká základna Nörvenich, Německo, 2001–2002

Jagdbombergeschwader 31 (zkráceně JaBoG 31), je stíhací bombardovací křídlo dislokované na letecké základně Nörvenich západním Německu. Jednotka vznikla v roce 1957 na základně Büchel, protože základna Nörvenich ještě nebyla připravena na provoz nové proudové techniky. Dne 20. dubna 1961 dostala eskadra jméno „Boelcke“ na počest Oswalda Boelckeho, stíhacího pilota Luftstreitkräfte z 1. světové války. V roce 1979 byla Jagdbombergeschwader 31 první jednotkou Luftwaffe, která zavedla do své výzbroje letouny Panavia Tornado IDS. V rámci restrukturalizace německého letectva byla 1. října 2013 přejmenována na Taktisches Luftwaffengeschwader 31 „Boelcke“ (zkráceně TaktLwG 31 „B“). Ve stejný den se také stala mateřskou jednotkou nové vzniklé skupiny taktického letectva „Richthofen“. V roce 2001 dostalo Tornado taktického označení 44+21 speciální barevné schéma k dosažení 1 250 000 letových hodin dosažených piloty Luftwaffe na letounech Tornado.

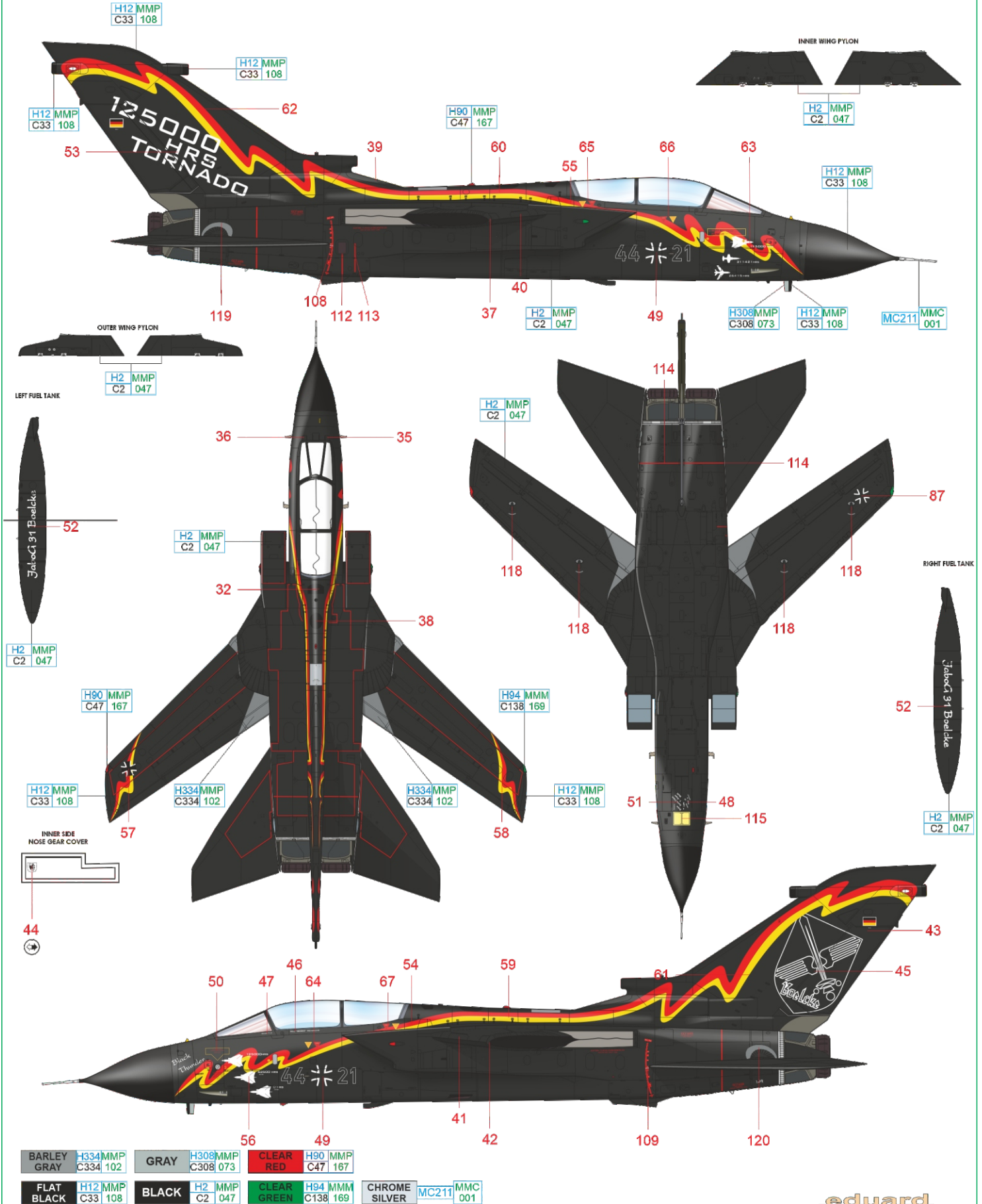

F AG 51 „Immelmann“, letecká základna Schleswig-Jagel, Německo, 2006–2007

Aufklärungsgeschwader 51, předchůdce TaktLwG 51, byla obnovena v lednu 1994. Předchozí AG 51 byla společně se sesterskou AG 52 (obě byly vyzbrojeny průzkumnými RF-4E) rozpuštěna v polovině roku 1993. Nově vzniklá AG 51 obdržela Tornada IDS, která byla doplněna také stroji verze ECR. Tygří zbarvení na letounu 44+87 bylo prvně prezentováno na setkání NATO Tiger Meet v roce 2006, konaném na španělské letecké základně Albacete. Kamufláž Tornada IDS 44+87 je provedena v tzv. Norm 5.

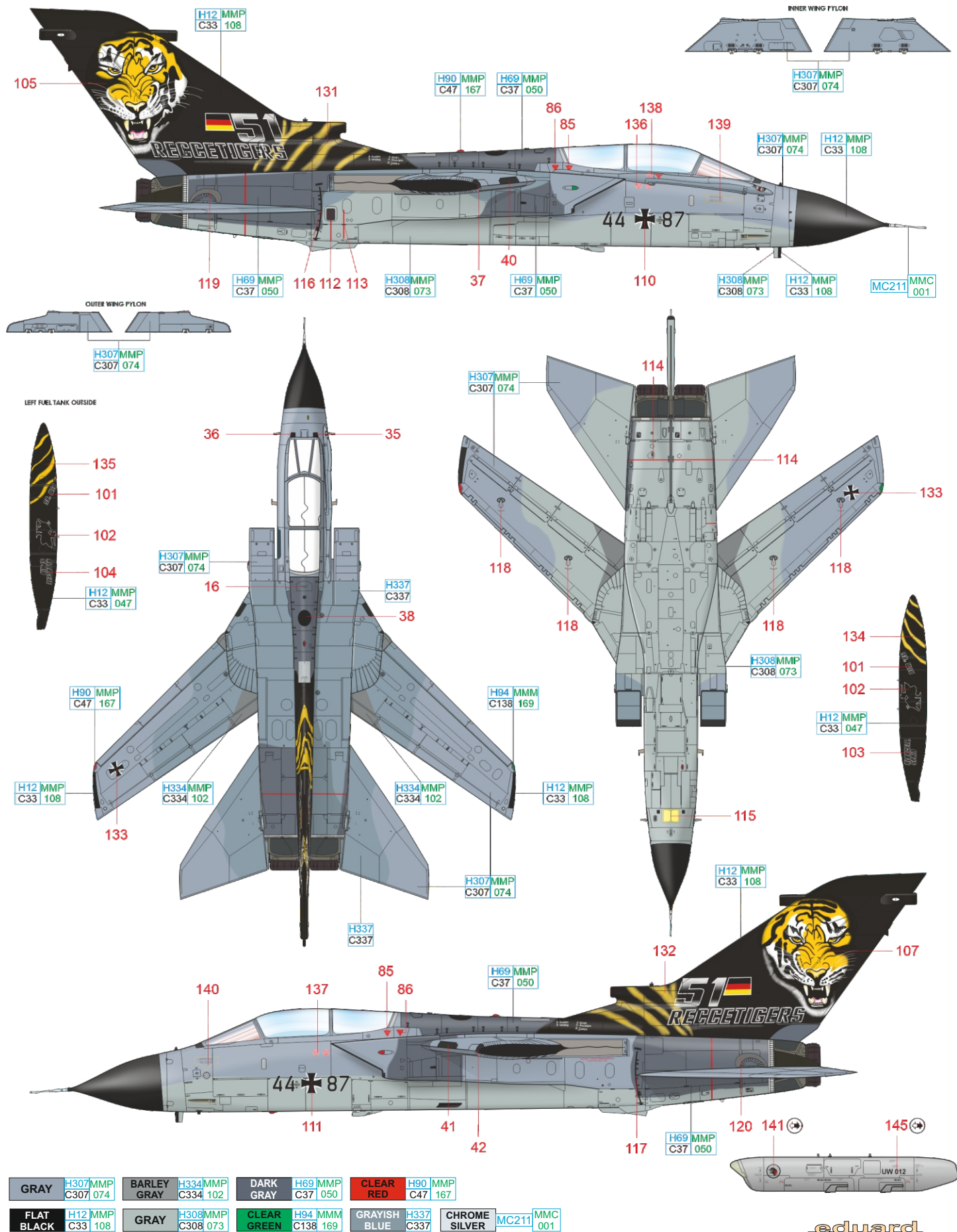

G JaBoG 33, letecká základna Büchel, Německo, 1999

Tato jednotka byla dříve známa pod označením Jagdbombergeschwader 33. V rámci restrukturalizace německého letectva byla 1. října 2013 přejmenována na Taktisches Luftwaffengeschwader 33. Sídlí v západním Německu na letecké základně Büchel a je jedinou jednotkou v německém letectvu schopnou nést jaderné zbraně. Kamufláž Tornada IDS 44+88 je provedena v tzv. Norm 83.

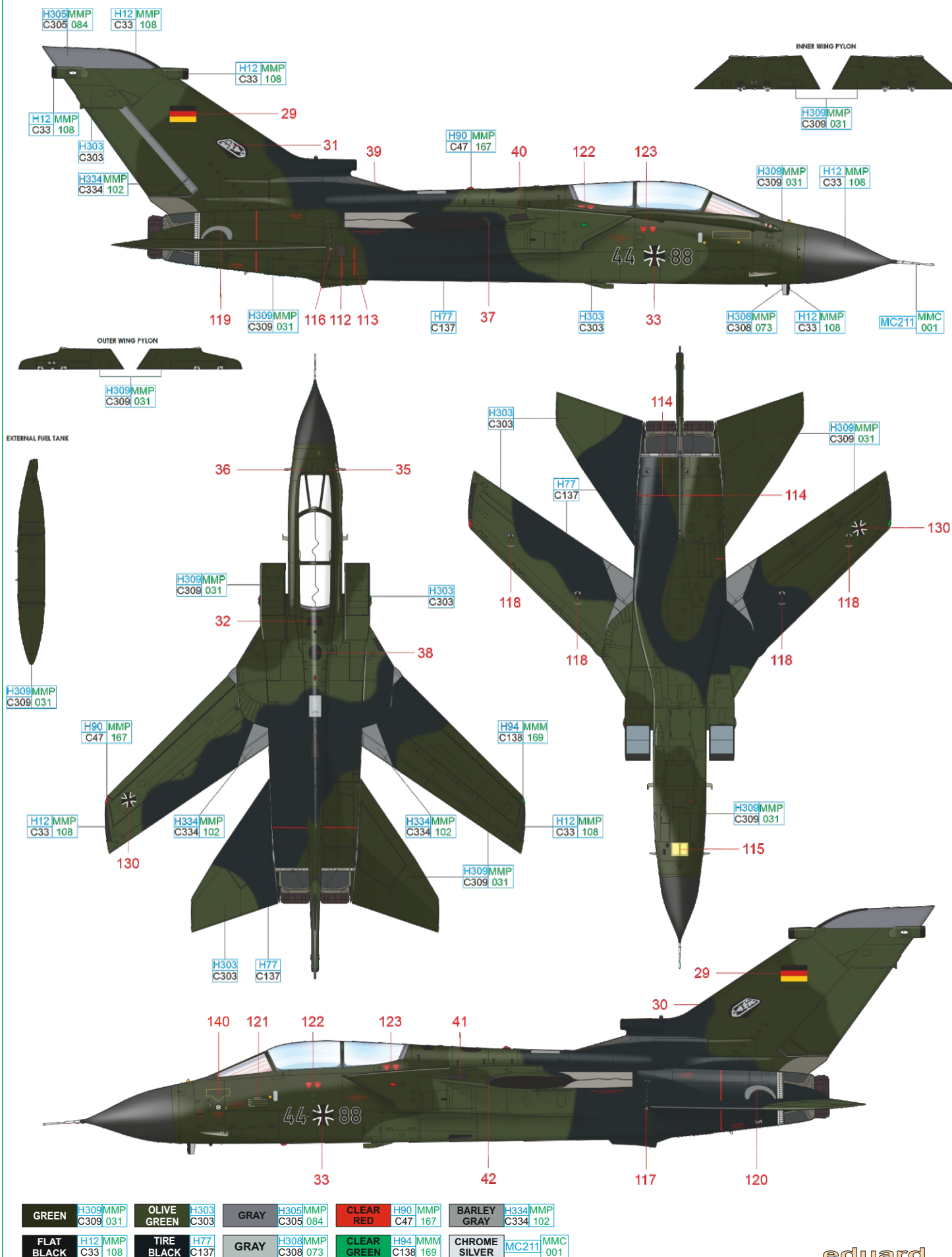

Note: For Camouflage D replace stencils S40 with stencils S43.

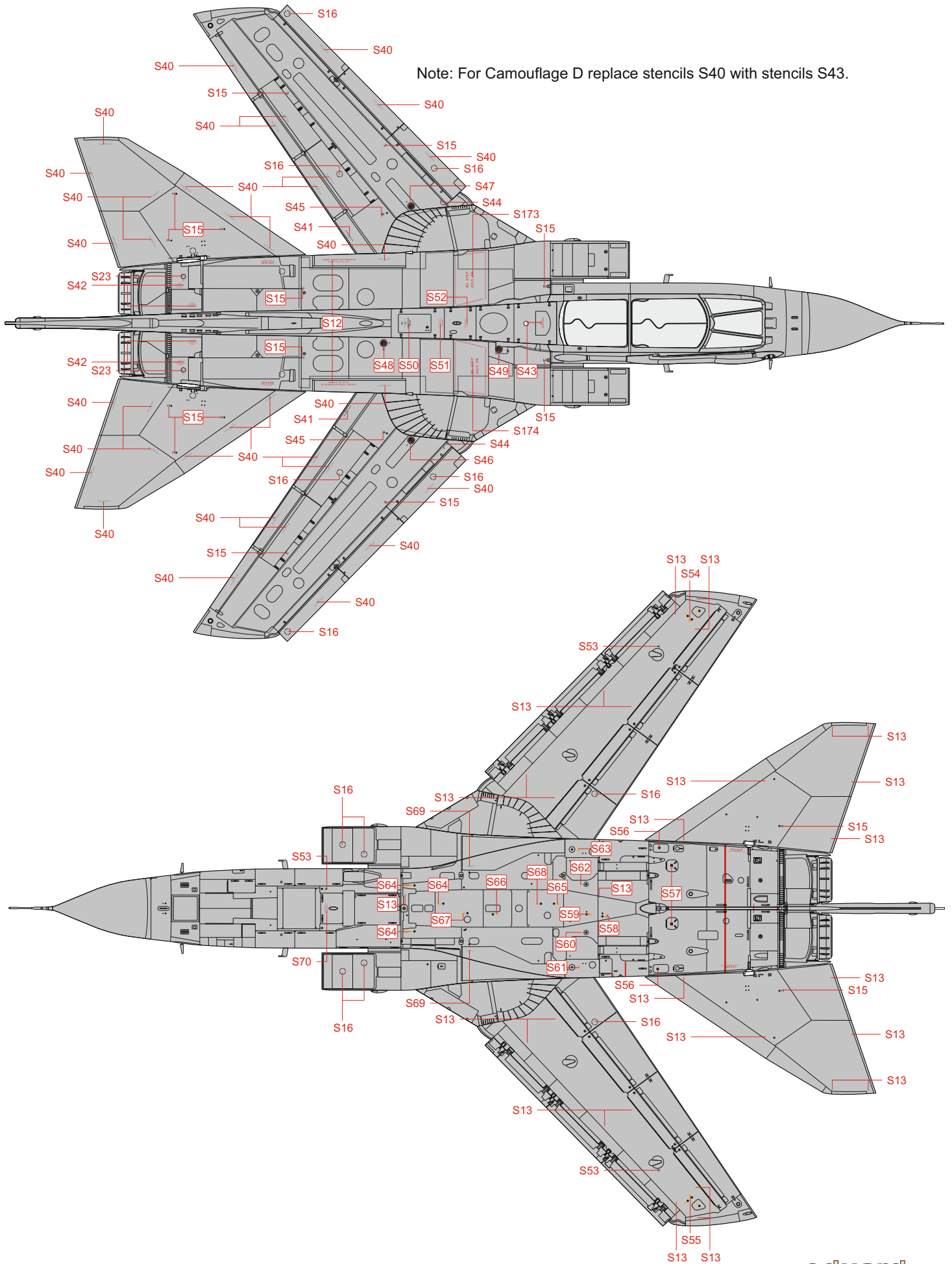

Auxiliary tank 1500l

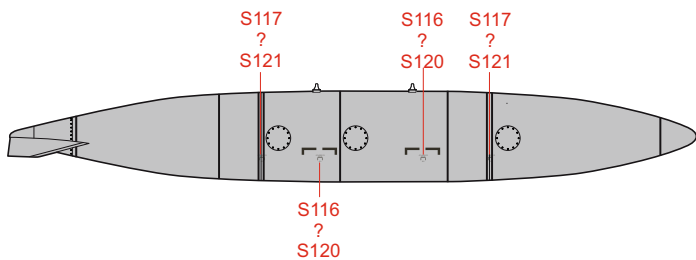
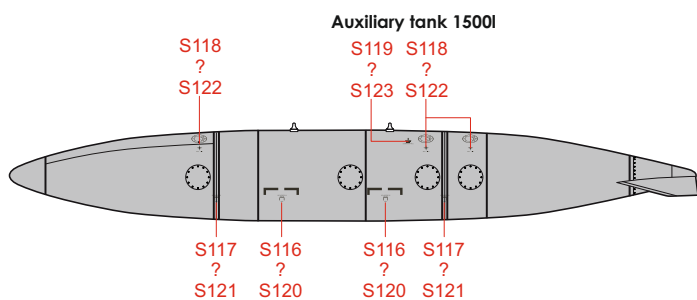

Bofors BOZ 101

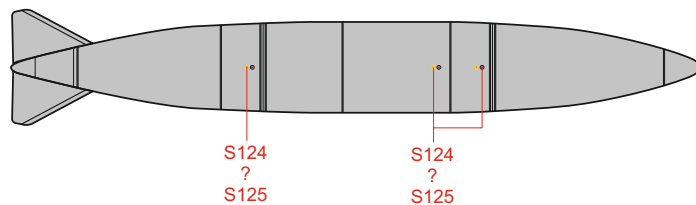
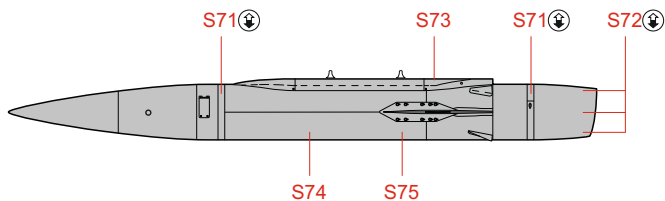

Cerberus III

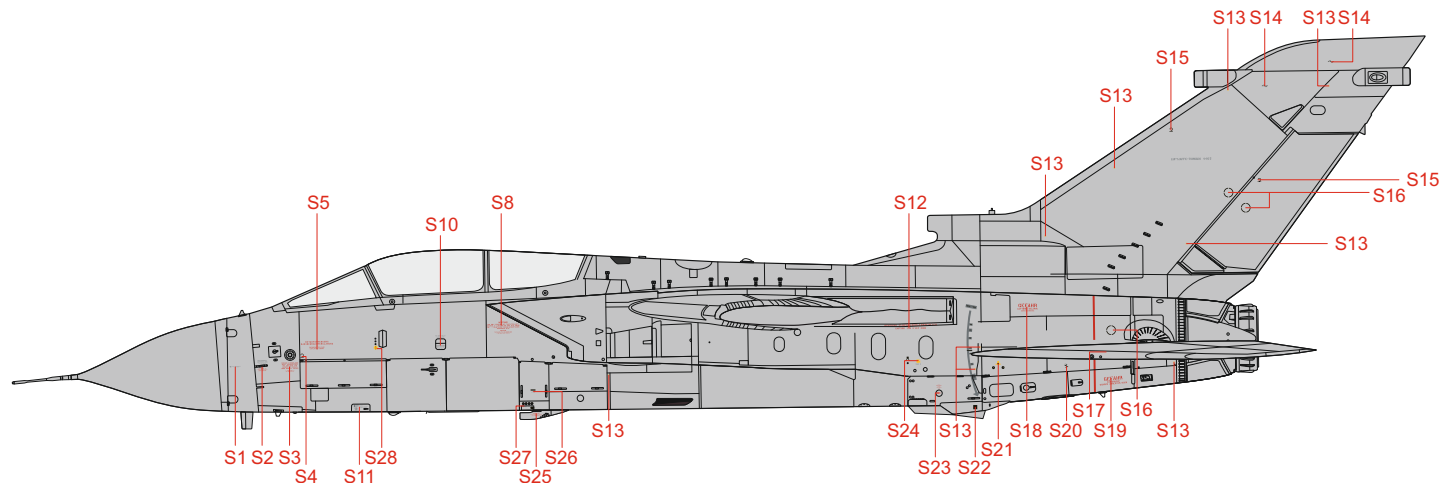
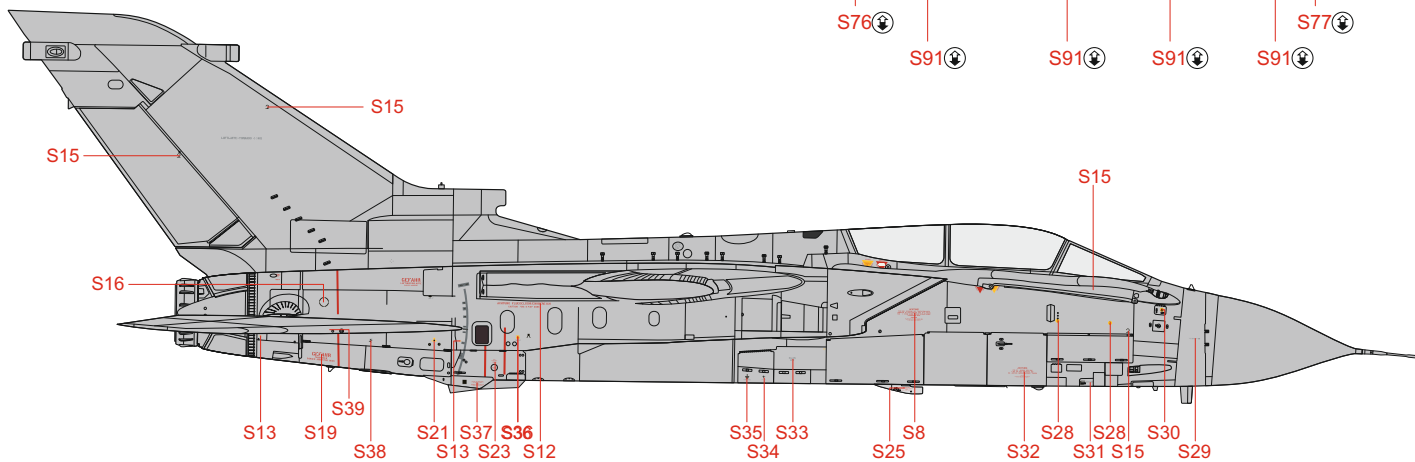
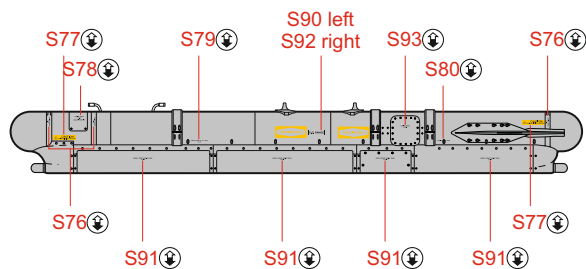

left outer pylon

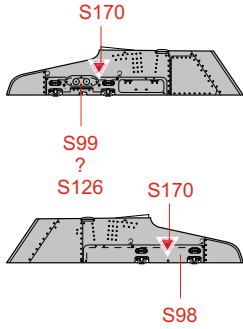

right outer pylon

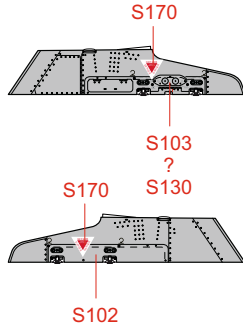

left inner pylon

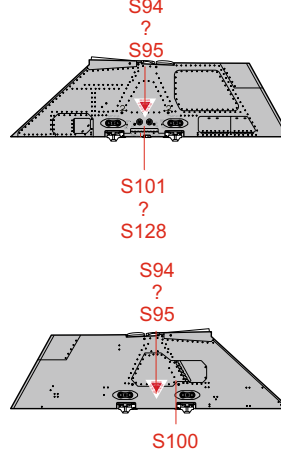

right inner pylon

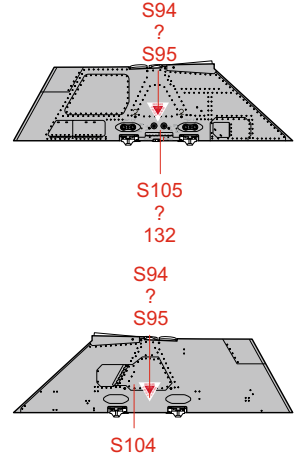

Right fuselage pylon

FWD →

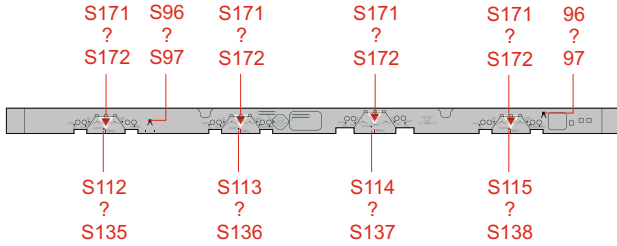

Center pylon - left

← FWD

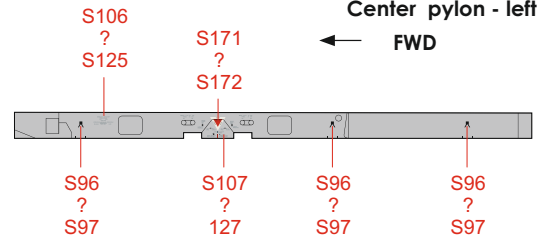

← FWD

Left fuselage pylon

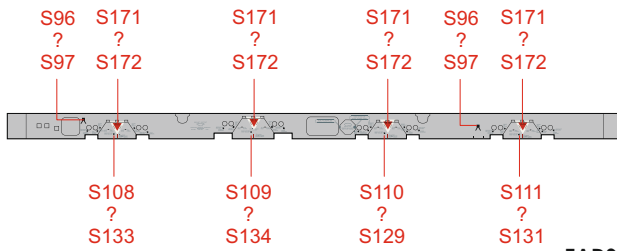

Center pylon - right

FWD →



EADS RECCE Pod

